

ई निविदा दस्तावेज E- TENDER DOCUMENT

भाग-II (प्राइस बीड) **PART-II** (PRICE BID)

(Rates to be filled in E-procurement portal)

(रेट्स केवल ई-प्रॉक्यूरमेंट पोर्टल में ही भरा जावे)

**शाखा शंकर नगर का फर्नीशिंग एवं इलैक्ट्रिकल कार्य
FURNISHING AND ELECTRICAL WORK AT
SHANKAR NAGAR BRANCH**



**क्षेत्रीय कार्यालय रायपुर
REGIONAL OFFICE RAIPUR**

PART-II

(PRICE BID)

Rates to be filled in E-procurement portal

(TO BE SUBMITTED ONLINE ONLY)

BILL OF QUANTITY

CENTRAL BANK OF INDIA

PROPOSED INTERIOR FURNISHING WORK FOR SHANKAR NAGAR BRANCH - RAIPUR (CG)

1. INTERIOR FURNISHING WORKS

S.No	ITEM AND SPECIFICATION	QTY	UNIT	RATE	AMOUNT
1.	ENTRANCE DOOR	63.00	Sq.ft.		
	Providing and fixing at site ,Double leaf Main entrance door made up of 10mm. thick float Glass fitted on top and bottom, vertical powder coated aluminium jumbo section(4mm thk.) . The door shall be made up of Two nos. single panel glass shutter with heavy duty Decorative Brush finished Stainless Steel handles (1'6"x1" dia SS handle). The door shall be fixed on specified floor spring and will have bottom lock. The shutters will have CENTRAL BANK mono /logo inscribed with film coating .the cost shall include all necessary fittings, all labour, materials, etc. complete.				
	BRANCH Ent. Door - 2 nos. X3'x7' =42 SFT				
	ATM Ent. Door - 1no. X3'x7' =21 SFT				
2.	FRONT FIXED GLAZING	99.50	Sq.ft.		
	Providing and fixing at site front fixed glazing with 10.0mm. thick float glass , fitted in top, bottom and vertical powder coated aluminum section (1.5mm thk.). The shutters will have CENTRAL BANK mono /logo inscribed with film coating .the cost shall include all necessary fittings, all labour, materials, etc. complete.				
	BRANCH Ent. Door TOP - (1X6'X3') =18SFT				
	ATM Ent. Door- TOP (1X3'X3') =9 SFT				
	ATM SIDE (7'3"X10') =72.50 SFT				
3	FULL HEIGHT FULLY/PARTLY GLAZED PARTITION INCLUDING DOORS:	170.00	Sq.ft.		

	<p>Providing and fixing at site fully glazed partition including door strictly as per the given design & drawing to be made up of 3"x3" box frame of 18mm ply or 2 1/4"x2 1/4" sal / hard wood section, finished with 6mm. Ply on all the sides, finished with 1.0mm. thick laminate finish on all the sides as per the given drawing. The glass portion is 8mm. thick float glass The glass is to be fixed to main frame with 1 1/4"x1" wood beading.. All exposed wooden members or beading to have 3 coats of melamine polish. The shutters will have CENTRAL BANK mono /logo inscribed with film coating .The cost shall include all necessary fittings, all labour, materials, etc. complete. The flush doors will be 32mm th. and will have door closer, door stopper, mortis lock in BM & night latch in Cash Cabin .(partitions to be fixed upto RCC ceiling but measurement upto false ceiling bottom will be considered for payment).</p>				
A	BM -13'X10'=130 SFT				
B	existing Cash Counter Repairing 5'x8'=40 SFT				
4	<p>LOW HEIGHT PARTITION</p> <p>Providing & fixing at site low height partition (4'0" height) to be made with 19mm. ply box frame or 2 1/4"x2 1/4" salwood / hardwood sections, to be finished with 6mm. ply & 1.0mm. Approved shade of laminated finish. The partition shall have either 1' high 12mm. thick float glass or soft board as per given drawing . The glass will have top corners chamfered and fixed with 1 1/2" x 1" wenge wood beading finished with 3 coats of melamine polish or D bracket . The partition shall have 1.0mm. thick laminate. The cost of partition should be inclusive of all materials, labor etc. complete.(As per drawing)</p> <p>Between Officer - 4NOSX4'x4' =64 SFT</p>	64.0	Sq.ft.		
5	<p><u>COLUMN/WALL PANELLING</u></p> <p>Providing & fixing at site wall paneling with 2"x1" salwood / hardwood frame work to be placed at 2' 0" c/c. The framing shall have 6.0mm. thick ply finished with 1.0mm. thick laminate approved shade Top of paneling on wall to be finished with 2-1/2"x2-1/2" teak wood decorative molding beading and shall be melamine polished. The cost shall include all materials, labor etc. complete.</p> <p>WALL- 80'X3'= 240 SFT</p>	240.00	Sq.ft.		
6	MANAGER TABLE (size 6'0"x3'0"x2'6") + SIDE CREDENZA (size 3'0"x1'6"x2' 6")				

	Providing & fixing at site Branch Manager Table to be made up of 19.0mm. ply finished with 1.0mm. thick laminate. The front of table shall have 3" strips of laminate & Steam beech shades laminated bands as per the given design & drawing. The table top shall have 10mm. glass top . The lower storage pedestal shall have 3 nos. sliding drawers & one open able shelves. The computer keyboard & drawers shall have heavy duty telescopic slide rails. Provision are to be made for wire manager ,CPU tray & foot rest. Inner surface of the table to have polish finish. The cost shall include all accessories etc. complete.	0.00	Nos		
7 (A)	FRONT COUNTER WITH 12MM FRONT GLASS Providing & fixing at site front counter 2'6" wide for staff to be made strictly as per the given drawing to be made up with 18mm. ply, finished with 1.0mm. laminate of approved shade to be fixed with 3" strips in front. The counter from inside shall have 1'8" wide x 2'3" deep storage unit with 2 nos. sliding drawers (& one open able portion) on heavy duty telescopic sliding rails and automatic latch arrangement .The counters shall have 12mm th. front glass as per given drg. The exposed edge surfaces are to be finished with 1 1/2"x1" beech wood beading with approved laminated finish shade and the inner surface is finished with 0.7 mm th inner laminate and cable manager are to be fixed as per drawing and design. Each counter shall have sliding keyboard. Provision shall be made for CPU tray & footrest in each counter. It also include one 12"x12" edge polished 12mm th. glass panel vertically fixed with SS stud with coloured eatched bank logo as per design and drawing. The work is to be completed with all labour and material including all the hardware required.	21.00	R.ft.		
	OFFICER				
8(A)	CASH COUNTER (7'6" high) Providing & fixing at site bulk cash counter strictly as per the given design & drawing to be made up with 18mm. ply with working top 3'0" wide & customer top 15" wide . with sliding key board and pedestal unit below, The pedestal unit shall have three nos sliding drawers with heavy duty sliding rails and automatic self closing locks All the exposed portions to be finished with necessary wooden beadings melamine polished and all the inside surfaces of the counter shall have two coats of plain polish / paint. The cost shall include all labor, materials, etc. complete. It also include one 12"x12" edge polished 12mm th. glass panel vertically fixed with SS stude with coloured eatched bank logo as per design and drawing.	0.00	R.ft.		
	CASH COUNTER -6 Rft				
8(B)	Providing and fixing at site aluminium ceiling grill size 3"x3" for cash counter top as per the given design including all labor, materials, etc. complete.	35.00	Sq.ft.		

9	STORAGES	70.00	Sft.		
	Providing & fixing at site storage cabinet 1'6" deep to be made up of 18.0 mm. ply with top & front finished with 1.0mm. laminated finish & 3" skirting of steam beech with teak wood beading on all edges & SS handles with horizontal & vertical shelves as per the given design & site requirement strictly as per the given design & drawing with magnetic catchers. Inside portion to be finished with clear polish finish The cost shall include all materials, locks, catchers, all labor etc. complete.				
	6'6"+8'+4'+4'x3'=70 SFT				
	-				
10	GLASS FILM-				
	Providing and pasting frosted glass film over B.M. cabin partition, Inbetween Officer partition & Front Fixed Glazing (entrance) as per given design.	200.00	Sq.ft.		
11	WICKET GATE	14.00	Sq.ft.		
	Providing and fixing at site wicket gate . wicket gate should be made up of 30mm.thk. flush door finished & laminated on both faces with 1.0mm. thick laminate of approved colour.				
12	FLUSH DOOR as per given specifications ,with door closer P&F Flush door double leaf 30 mm thick with laminate on both side including necessary hardware like lock , door closer , handles tower bolt etc complete.	21.00	Sq.ft		
	1nosx3'x7' = 21 SFT				
13	NOTICE BOARD	2	Nos.		
	Providing and fixing at site notice board of size 3'x2' to be made up of 12.0mm. thick soft board fixed on 12.0mm. ply finished with fabric as per architect choice. The soft board shall have 1 1/2"x3/4" teak wood beading on all sides and melamine polished. The shall include all materials, labor charges etc. Both for Branch & ATM.				

14	CHEQUE/SUGGESTION DROP BOX P&F cheque drop box 1'x1'6"x1' deep made out of 18mm plywood duly (steam beach) laminated finished on all external exposed surfaces & white enamel paint internally. Item to include slot for dropping cheque and shutter with multipurpose lock.	2	Each		
15	Writing platform for customers & application form set Providing , fitting , fixing writing plat form at a height of 4' above floor level fixed to the wall made out of 19 mm BWP block board with lamination 1 mm tk on top & hard wood beading ducco painted . At least 10 nos vertical slip in chalan shelves attached to wall over writing platform made out of min 4 mm tk acrylic sheets with 6 mm tk ply back up. Each chalan shelf will be of size 6" height , 6" wide .The entire unit will be complete in all respect including materials ,labor etc to the satisfaction of consultant .	3.0	Rft		
16	ACP WORK - PANELLING & SHUTTER BOXING Panelling work with Aluminium composite panel (4mm thk.) IN ATM Wall panelling and shutter boxing etc.	390.00	Sq.ft.		
A	ATM- wall paneling - 30'x8' =240 SFT				
B	ENTRANCE wall paneling - 4'x10' = 40SFT				
C	Shutter boxing - 20'x5'+10 = 110 SFT				
17	PVC/ ALUMINIUM LOUVERS (ATM) P&F pvc/aluminium louvers 2'6"x1' over inside partition complete.	1	Each		
18	PUTTY & ACRYLIC PAINT (1 COAT only) P&applying of putty & single coat of acrylic paint of approved brand over already painted walls with minor touch up work to give a finished look .	1500.00	Sq.ft.		
19	<u>VERTICAL BLINDS</u> Providing and fixing at site vertical blinds 4" wide vertical blinds Vista make only with extruded powder coated head rail housing control units, spacers, runners, tilt rod with reduction gear mechanism, tilt control for rotation for rotation of 180 degree louvers made of approved fabric/color scotch guard coating & bottom mechanism of powder coated galvanized steel with required components. Shades & colors shall be decided as per architect.	150.00	Sq.ft.		

20	GYPSON CEILING BANDS AT EDGES WITH PLASTIC PAINT (2-3 COAT) Providing and fixing gypsum false ceiling 2' to 3' width at edges as per the given design in 12.5mm. thick Gypboard (POP) plain false ceiling with GI suspended from RCC slab/Beam as approved by Bank/Architect including G.I. Parameter Channels of size 0.55mm. thick having one flange of 20mm. and another flange of 30mm and web of 27mm along with parameter of ceiling, screw fixed, to the brick wall / partition with the help of nylon sleeves and screws at 600mm. C/C. The suspended G.I. Intermediate channels of size 45x0.9mm. thick with two flanges of 15mm. each from the soffit at 1200mm. C/C with GI cleats and steel expansion fasteners. Ceiling sections of 0.55mm. thick having web of 51.5mm. and two flanges of 26mm. each with lips of 10.5mm. (Finished vertical band will be considered for measurement) (Branch + ATM)	600.00	Sq.ft.		
22	ARM STRONG CEILING Providing and fixing of false ceiling at all heights of 600mmx 600mmx12mm arm strong mineral fiber ceiling tiles laid on arm strong prelude XL exposed grid systems with 9mm wide T Section flanges colour white. The frame work comprise of main runner spaced at 1200mm centers securely fixed to the structural soffit approved hangers at 1200mm maximum centers. Hangers (GI wire) to be fixed by approved roof plug and screws etc. The last hanger at the end of each main runner should not be greater than 450mm. from the adjacent wall. flush fitting 1200mm. along cross tees (with double stitching) to be interlocked between main runners at 600mm. c/c to form 1200x600mm modules. Cut cross tees longer than 600mm to be supported independently. 600mmx600mm modules to be formed by fittings 600mm long flush fitting cross tees centrally between the 1200mm cross tees. Perimeter trim to be arm strong wall angle secured to walls at 450mm. maximum centers.	400.00	Sq.ft.		
23	Electrical panel board cover Providing and fixing of electrical panel board cover made up of 19mm ply with two shutter at the front having T.W luvvers as per drawing and design, it allso have furnished with locking arrangement. The exposed surface is finished with 1mm. Th. Laminates and inner surface is finished with two cote of plastic emulsion paint over one coate of primer . The work should be completed including all hardware, material and labour.	24.00	Sq.ft.		
24	LAMINATE PASTING OVER EXISTING FURNITURE Removal of existing laminate and providing and fixing 4mm thk. Ply and 1mm thk laminate pasting over existing, storage , partitions ,shutters, wall paneling, tables etc.	50.00	Sqf.t		
25	NEW SHUTTERS IN EXISTING STORAGE Removal of damaged shutters and Providing & fixing new storage shutters to be made up of 18.0 mm. ply finished with 1.0mm. laminated finish & 3" skirting of steam beech with teak wood beading on all edges & SS handles as per the given design with magnetic catchers. Inside portion to be finished with paint or linear mica. The cost shall include all materials, locks, catchers, all labor etc. complete.	50.00	Sqf.t		
26	Shifting of existing furniture work like Tables, chairs, partition, storage etc and refixing the same.	1	JOB		
TOTAL FOR INTERIOR WORKS Rs.					

CENTRAL BANK OF INDIA

ESTIMATE OF ELECTRICALS WORK FOR SHANKAR NAGAR BRANCH - RAIPUR (CG)

2. ELECTRICAL WORKS

S.No.	Particulars	Qty.	Unit	Rate	Amount
ELECTRICAL					
	SUBHEAD I (POINT WIRING)				
	The rates for the point wiring shall include providing and fixing of following:				
a.	Wiring of the point of any length from distribution board to point outlet excluding circuit wiring				
b.	Earthing of all switch box and all outlet boxes fitting, fans, 3rd pin of plug with 1.50mm copper wire.				
c.	Modular Switch/ Sockets of Standard make with necessary modular series cover plate and MS Boxes				
d.	Embedding all conduits in walls laying in slabs, above false ceiling or in floors including all accessories as required, cutting and refilling the chases with cement mortar .				
e	Providing, fixing Modular switches, sockets, M.S. boxes (1.6mm thick) draw boxes, G.I. Pull wires (where required), brass screws, ceiling rose/connector etc.				
f	Adopting separate and independent system of wiring for lighting, power (normal and essential supply). Wiring for following points using PVC insulated copper conductor wires of 650V/1100V grade in 16 SWG M.S. conduit stove enameled concealed/ exposed including switches & sockets as above.				
INTERNAL WIRING					
1	POINT WIRING :				
	Providing wiring (supply, fixing, testing and comm. etc) for light point / Exhaust fan point / Call bell point etc with 1.5 sq mm FR PVC insulated copper conductor single core multi stranded wire in 16 swg stove enameled rigid steel conduit with conduit accessories like bend , junction box etc in concealed/surface manner as per site requirement with suitable Modular Switches with plate and metal / PVC box, ceiling rose , bulb holder etc including 1.5 sqmm FR PVC insulated copper earth wire etc complete as required. Wire colors : Red, Black, Green .				
a.	Providing and fixing one light point controlled by one switch	25	Nos.		
b.	Providing and fixing two light point controlled by one switch for downlighters	15	Nos.		

	d	Plug point (for wall and exhaust fans)Supply, fixing and commissioning of 1 No 6A multi Socket with 1 No. 6A switch (Modular type) with cover plate, sheet steel box / PVC modular box etc on surface / concealed manner l/c electrical connections and making good all the damages, painting, cleaning the site etc. complete as required as per site requirement and as directed.	11	Nos.		
	e	P&F bell point i/c of buzzer	1	Nos.		
	f	Ceiling fan point with Fan hook	3	Nos.		
2		CIRCUIT WIRING FOR LIGHT BOARDS :				
		Supplying, providing wiring (supply, fixing, testing and comm. etc) for Lighting circuit with 2 x 2.5 + 1 x 1.5 sq mm FR PVC insulated copper conductor single core multi stranded wire in 16 swg stove enameled rigid steel / PVC heavy duty conduit with conduit accessories like bend, junction box etc on surface / recessed manner etc (Wiring from D.B. / Source to Board/destination) and making good all the damages, painting, cleaning the site etc complete as required as per site requirement and as directed (average length of circuit taken as. (12-15) M	5	Nos.		
3		6 AMP. POINTS ON SAME BOARD :				
		Supply, fixing, testing and commissioning of 1 No 6 A Multi Socket with 1No. 6 A switch (Modular type) with cover plate , sheet steel box / PVC modular box etc on surface / concealed manner l/c electrical connections and making good all the damages, painting, cleaning the site etc complete as required as per site requirement and as directed.	5	Nos.		
4		16 AMP. POWER POINTS:				
		Supply, fixing, testing and commissioning of 1 No 16 A switch & 1 No. six pin 6/16 Amp. Multi Socket (Modular Type) with cover plate , sheet steel box etc on surface / concealed manner l/c electrical wiring with 2 X 2.5 sqmm + 1 X 1.5 sqmm FR PVC insulated copper conductor single core multi stranded wire in 16 swg stove enameled rigid steel /PVC heavy duty conduit with conduit accessories like bend, junction box etc on surface / recessed manner etc (Wiring from D.B. / Source to Board/destination) and making good all the damages, painting, cleaning the site etc complete as required as per site requirement and as directed.	5	Nos.		
5		AC POINTS :				

		Supply, Installation, Testing and commissioning of the surface / recess mounting distribution board with 20 A/25A plug and socket, with 20 A SP MCB Incl. wiring with 2 X 4.0 sq mm + 1 X 2.5 sqmm FR PVC insulated copper conductor single core multi stranded wire in 16 swg stove enameled rigid steel / PVC heavy duty conduit with conduit accessories like bend, junction box etc on surface / recessed manner etc (Wiring from D.B. / Source to Board/destination) and making good all the damages, painting, cleaning the site etc complete as required as per site requirement and as directed.				
		With 20A plug & socket	5	Nos.		
		<u>PANELS AND D.B.'s</u>				
-						
6		<u>MAIN PANEL :</u>				
		Supply, delivery, installation , testing , commissioning , of L&T make indoor wall / floor mounted type distribution boards made out of 2 mm thk. CR sheet metal duely acid treated premised & painted with 2 coats of enamel paint compartment arrangement for each equipment & bus bar chamber on the top of the panel running horizontal through out its length duly lamp , vermin proof having provision cable by conduit entry , earthling stud as per specification mentioned below duly factory wired confirming to the relevant ISS & as per special condition of contract , making good the damages M.S. Cubical type Panel board should have hinged door at the front. The panel shall be provided with all accessories & following arrangements complete in all respect & direction of EIC (before fabrication of panel board drawing is to be approved by Engineer-in-charge).	1	Nos		
		<u>Incoming-</u>				
		1No 160A- 30KA - 4POLE -MCCB.				
		1 set of 125A TPN copper bus bar				
		1 set of 63 A TPN copper bus bar				
		63A, 4-POLE Change over				
		<u>Out going-</u>				
		2 Nos. of 63A 4P MCB for Branch UPS Incomer - 1 + 1 (Spare)				
		2 Nos 40 A DP MCB for LDB/PDB - 1 + 1 (Spare)				
		2 Nos 63 A DP MCB for AC DB - 1 + 1 (Spare)				
		1 Nos 16/20A DP MCB for Glow sign board				
		6 Nos- 10 / 25 Amp DP MCB (ATM light & AC)				
		1 No. VAF Digital meter with CT.				
		6 Nos Phase indicator lamps				
		Timer with contactor for ATM AC				

8		MASTER MCCB -125 Amp 125A MCCB with double door enclosure for turn off all the electrical supply excluding UPS supply while Branch shut down.	1	Nos		
9		<u>LIGHT DISTRIBUTION BOARD</u>				
		Supply, Installation, Testing and commissioning of the surface / recess mounting following way MCB three phase distribution board for single phase outgoing with IP 42 protection , direct on wall incl. the followings accessories				
		INCOMER				
		1 No. TPMCB 40 Amp				
		OUTGOINGS				
		6-8 Nos SPMCB 6-10 Amp				
		SET AS ABOVE	1	Nos		
		incl. Electrical connection ,earthing, making good all the damages, painting, cleaning the site, etc complete as per site requirement and as directed.				
10		<u>AC DISTRIBUTION BOARD</u>				
		Supply, Installation, Testing and commissioning of the surface / recess mounting following way MCB three phase distribution board for single phase outgoing with IP 42 protection , direct on wall incl. the followings accessories				
		INCOMER				
		1 No. TPMCB 63 Amp				
		OUTGOINGS				
		8 Nos DPMCB 25 Amp + 2 Nos Spare				
		SET AS ABOVE	1	Nos		
		incl. Electrical connection ,earthing, making good all the damages, painting, cleaning the site, etc complete as per site requirement and as directed.				
		<u>SUBHEAD IV : UPS WIRING</u>				
11		U.P.S. DISTRIBUTION BOARD (INCOMER)				
		Supply, Installation, Testing and commissioning of the surface / recess mounting following way Double door MCB D.B.- Single phase distribution board (Consumer unit) for single phase out going with IP 42 protection incl. the followings accessories – incl. Electrical connection ,earthing, making good all the damages, painting, cleaning the site, etc complete as per site requirement and as directed.				

	a.	INCOMER (Branch & ATM)				
		1 NOS 63 A TPNMCB				
		OUTGOINGS				
		2 Nos- 40 Amp TPN + 1 Spare				
		SET AS ABOVE	2	Nos		
	b	<u>UPS DIST. BOARD OUTGOINGS.</u>				
		1 NOS 12 WAY SPN DIST BOARD				
		1 Nos- 40 Amp SPN				
		6-8 NOS 6 AMP SPMCB				
		SET AS ABOVE	2	Nos		
12		<i>SPECIAL POINTS: (UPS) any length</i>				
		Supply, fixing, testing and commissioning of following Modular type switch socket with cover plate , sheet steel box etc on surface / concealed manner l/c electrical wiring with 2 X 2.5 sq mm + 1 X 1.5 sq mm FR PVC insulated copper conductor single core multi stranded wire in rigid 16 swg stove enameled rigid steel conduit with conduit accessories like bend, junction box etc on surface / recessed manner etc (Wiring from D.B. / Source to Board/destination) and making good all the damages, painting, cleaning the site etc complete as required as per site requirement and as directed.				
		2 Nos. 6 A Switch + 3 Nos. 6 A, 5 pin Socket.	20	Nos.		
13		<u>CHEMICAL EARTHING</u>				
		Preparation of the Earth station : (as per I.S. 3043)				
		a). Excavation of rocky earth,soft murrum, hard murrum etc and back filling with black cotton soil for the earth station, the earth pit size is 1000 mm X 1000 mm X 2500 mm deep.				
		b). S/F of Copper earthing electrode of size 1m.				
		c). Supply & fixing of conductive back fill compound 25kg for 2mtr. /50 kg. for 3mtr.				
		d). S/F of copper electrode model no n80 (length 2000/3000, inner pipe 42.4mm x2.6mm, outer pipe 76.3mmx 3.2 mm & coating 80-100 microns.	2	Nos.		
14		Supplying and laying 25 X 3 mm copper strip direct on wall/ in ground with screws and washer including soldering / welding etc if required..	10	Mtr.		
15		Supply and laying of 4.0 sqmm PVC insulated copper wire from earth station to main panel board in 16 G MS conduit including all materials, accessories etc complete.	25	Mtrs.		

CABLING :						
16		L.T.CABLES :				
		Supply,laying ,testing and commissioning of the following 1100 volt grade FR PVC insulated Cu. Conductor armored cable inner and outer sheathed , along with the two run of G.I.earth wire i/c termination with brass gland and Al. lugs etc. complete as required.				
	a	On surface :				
		S/Fixing the cable on wall / column / beam / ceiling / above false ceiling / existing trench etc incl. s/f of of saddles / spacers (wherever required as per site conditions) and two run of G.I. earth wire along with the cable. Making good all the damages				
	b	4 C x 10.0 sqmm armored FR PVC copper cable with 10 SWG 2 Nos G.I. wire for ups room	50	Mtrs.		
	c	3.5 C X 35 sqmm. Al. Armored .(with 10 SWG 2 Nos. G.I. wire) from meter to electric panel and master MCB	10	Mtrs.		
TELEPHONE WIRING / CABLING SYSTEM.						
17		TELEPHONE POINT :				
		Supplying, Installation, testing and commissioning of the telephone point with the followings -				
	a.	Two pair, 0.61 mm dia. telephone cable tinned copper conductor, P.V.C. insulated and sheathed , fire retarding, anti termite, color coded twisted pairs and rip cord.	20	Mtr		
	b	HMS Pvc pipe on beam /column / wall / / floor etc with all necessary materials i/c connections, identification by numbering etc complete as required as per I.T.D. specification.				
	c.	Double outlet with shutter modular type Telephone Outlets (RJ – 11) with suitable size M.S./ PVC modular boxes complete as required .	1	Nos.		
	d	Single outlet with shutter modular type Telephone Outlets (RJ – 11) with suitable size M.S./ PVC modular boxes complete as required .	12	Nos.		
18		<u>Light</u>				

		Supply, fixing, testing and commissioning of Recess mounted LED luminaries with complete PMMA difuser in metallic frame, held securely to the main body, epoxy, white powder coated CRCA sheet steel housing, pre wired with vacuum presser impregnated copper ballast. RATED LIFE SHOULD BE MORE THAN 50000 BURNING HOURS (WITH REPLACEMENT GUARANTEE OF THE SUPPLIER) MAKE: WIPRO / Philips / Crompton / GE / Havells / OSRAM /SYSKA (5 STAR RAITING)				
	a	38W Approx. Dimensions:600 X 600 mm	10	Nos.		
	b	14w (High efficiency circular LED Downlighter)	30	Nos.		
	c	20W Coral LED , T-5	5	Nos.		
	d	12 watts LED bulb with complete fixture	2	Nos.		
19		<u>FAN FIXTURES</u>				
	a	<u>WALL BRACKET FAN (5 star rating)</u>				
		Supply and fixing of the following fans Wall bracket fan white (400mm blade size) crompton, Bajaj or equivalent make.	2	Nos.		
	b	<u>CEILING FAN crompton, Bajaj or equivalent make.</u>	2	Nos.		
	c	<u>EXHAUST FAN:(5 star rating)</u>				
		Supply and fixing of the following single phase Exhaust Fan continuously rated, capacitor start and run type, totally enclosed and ruggedly built, pre lubricated double ball bearing, copper wound, A & E class insulation, dynamically balanced, below 40 db sound level etc. Supplying & fixing of 300 dia Exhaust fans (Crompton, Bajaj or equivalent make)	2	Nos.		
	d	<u>REFIXING OF OLD LIGHT, WALL FAN,EXHAUST FAN ETC</u>				
		Refixing of light, fan etc	20	Nos.		
20		P/F 9U racks	1	Nos.		
		<u>indicator light set.</u>				
21	A	Supply and laying of 4 core 2.5 sqmm PVC insulated copper wire for 3 nos 5watt indicator light including all materials, accessories etc complete.	20	Mtrs.		
	B	Providing and fixing of 3 nos led 5watt indicator light set.	1	set		
<u>COMPUTER CABLING SYSTEM.</u>	-					

		COMPUTER POINT : I / O's :				
22		Supplying, Installation, testing and commissioning of the Computer point with the followings -				
	a.	Four pair STP CAT 6 LAN cable tinned copper conductor, P.V.C. insulated and sheathed , fire retarding, anti termite, color coded twisted pairs and rip cord.				
	b	HMS Pvc Pipe on beam /column / wall / floor etc with all necessary materials i/c connections, identification by numbering etc complete as required as per At & T specification.				
	c.	Single outlet with shutter modular type I / O's Outlets (RJ – 45) with suitable size M.S./ PVC modular boxes complete as required	12	Nos.		
23		Supply and Installation of following factory fabricated patch cords (STP-CAT 6) complete with connectors and boots on both sides.				
	a.	Two Meter length	12	Nos.		
24		Supply and laying of Four Pair STP CAT 6 LAN cables including cost of 25mm dia 1.5mm thick PVC Conduit / Floor trunking.	300.00	Mtrs.		
25		SHIFTING OF C.C.CAMERA	1.00	job		
		Shifting of existing c.c.camera refixing the same.				
26		SHIFTING OF UPS	1.00	job		
		Shifting of existing c.c.camera refixing the same.				
27		Shifting of existing AC units and servicing,gas filling , repairing & refixing the same.	3	nos		
TOTAL FOR ELECTRICAL & COMPUTER CABELING WORKS					RS.	

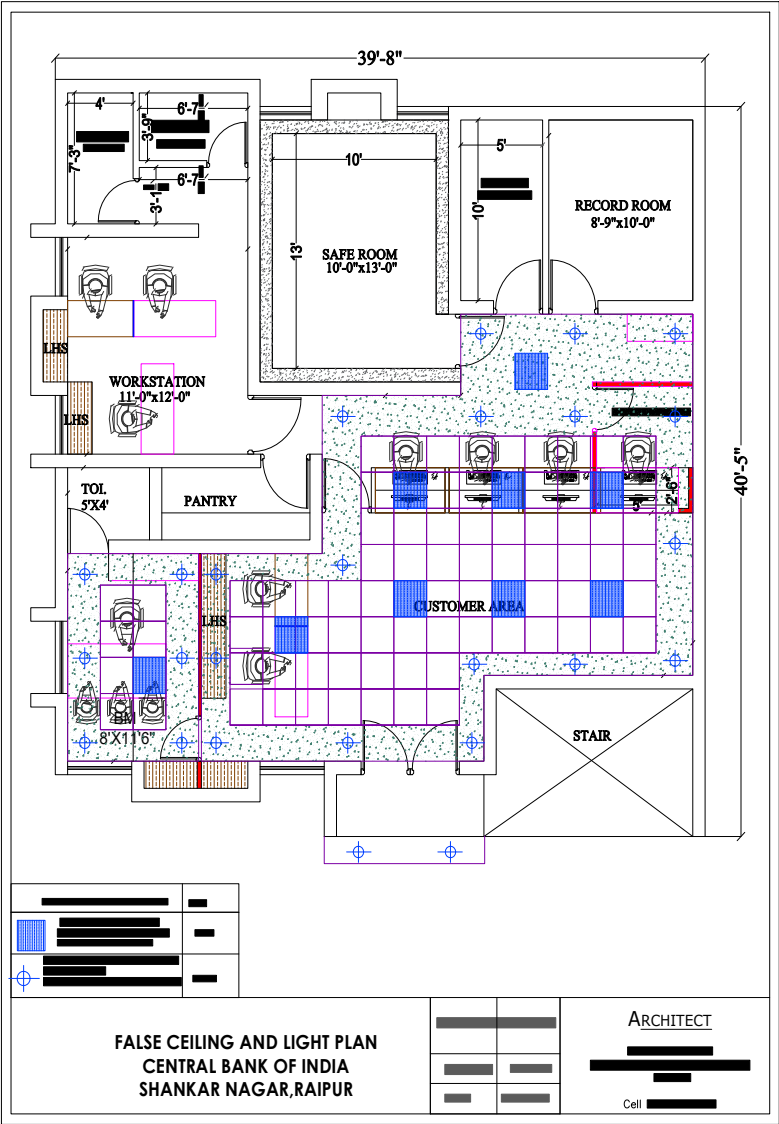

ABSTRACT**SUB: FURNISHING AND ELECTRICAL WORK AT SHANKAR NAGAR BRANCH**

Sr. no.	Particulars	Amount
1	Furnishing work (Part-A)	<i>To be filled in E-procurement portal only</i>
2	Electrical and allied work work (Part-B)	
3	Total (1+2)	
4	Discount if any	
5	TOTAL (3 - 4)	

The Prices quoted must be inclusive of all taxes, duties labour, transporation etc. **except GST. GST will be reimbursed as applicable.*

**Seal & Signature
of Firm,**