

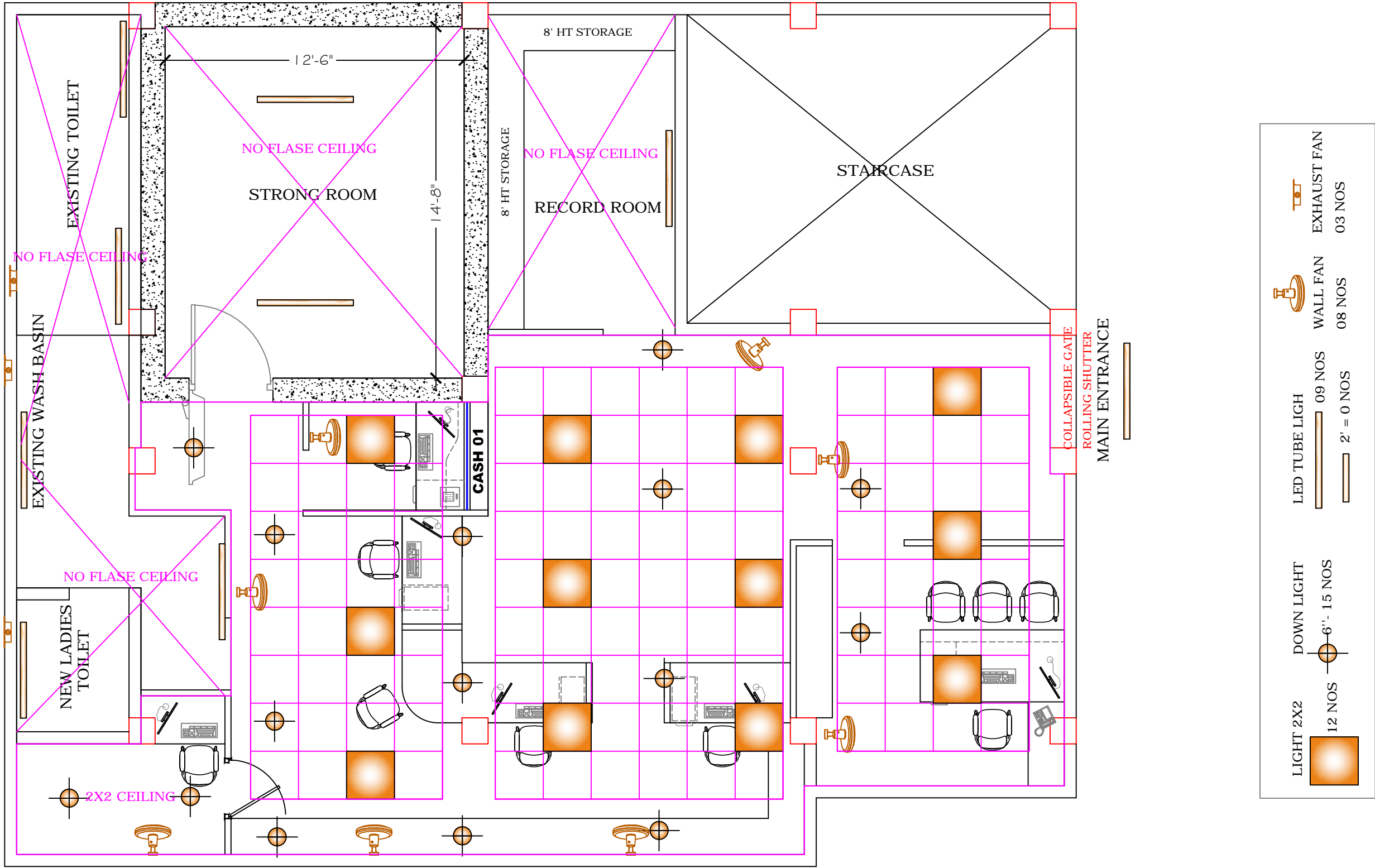

NOTE: THIS DRAWING IS A COPYRIGHT. CONTENTS OF THE DRAWING OR PART THREREOF MAY NOT BE USED OR REPRODUCED WITHOUT THE PERMISSION OF M/S. ARCHTECH.

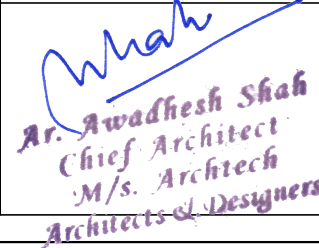

RCP OF DHUPDHARA BRANCH (1ST FLOOR), DHUPDHARA, ASSAM

PROJECT DETAIL	PROPOSED FLOOR PLAN OF DHUPDHARA BRANCH	DIRECTION	Project dealt by: Ar. Awadhesh Shah	SEAL & SIGNATURE 	FIRM'S NAME & ADDRESS ArchTech Flat no. E2, Arun Enclave, Om Path, Opp. Sanskriti The Gurukul School, Ahom Gaon, Guwahati-781035 Contact no.: +91-70052-05165 Email ID: awadheshshah123@gmail.com	 ARCHITECTS & DESIGNERS
	CLIENT: CENTRAL BANK OF INDIA, BARPETA REGIONAL OFFICE BARPETA MAIN ROAD, BARPETA-781 315 (ASSAM)		Carpet area: SFT Date:- 26-02-2024			
DRAWING FOR APPROVAL		DRAWING NO. 01				