







CENTRAL BANK OF INDIA,
Mumbai Metropolitan Zonal office

LEGEND

| | |
|---|-----------------------------|
|  | Brick Wall |
|  | 12" RCC Wall |
|  | Full Height Glass Partiti |
|  | Half Height Partition |
|  | Counter Partition to Deta |
|  | Half Height Glass Partitic |
|  | Full Height Solid Partitioi |

NOTES

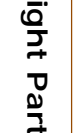
- 01. DO NOT SCALE, ALL DIMENSIONS ARE IN MM UNLESS STATED OTHERWISE.
- 02. ANY DISCREPANCIES TO BE REPORTED IMMEDIATELY TO THE ARCHITECT.
- 03. Strong Room Concrete wall as per specifications
- 04. All Internal brick walls are 4.6 inches, All External brick walls and common wall between ATM and UPS room 9 inches
- 05. Windows as per measurement in the dwg w 12mm grill at 6" C/C both ways

PROJECT:

PROPOSED LAYOUT FOR B/O Dhundalwadi
under MSRO

DRAWING TITLE:

SCHEMATIC LAYOUT



| | | |
|---------------|--------------------|---------|
| SCALE: N.T.S. | DRAWN: AMAR | CHKD: |
| 23-08-2023 | STATUS: FOR TENDER | |
| REF: | DRG.NO: 01 | REV: 01 |

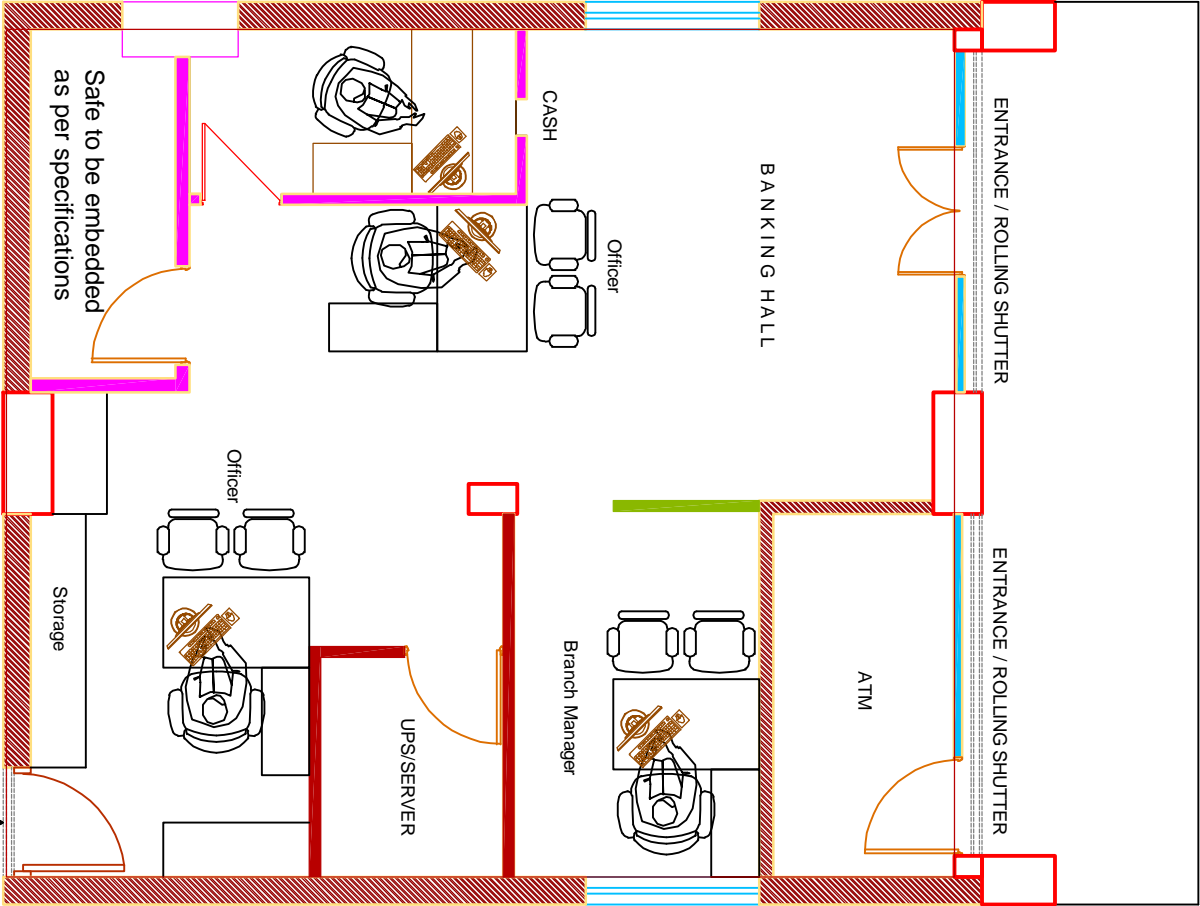

Back Door to be provided with
Collapsible gate and shutter for
access to toilets