

Central Bank of India

Regional Office, Gandhinagar
Address: 4th floor Lal Darwaza Building, Ahmedabad

Tender **TECHINICAL BID** (To be kept in envelope -1)

❖ NAME OF THE WORK:

**TENDER FOR RENOVATION, FURNITURE, ELECTRICAL AND DATA CABLING WORK OF REGIONAL OFFICE AND CPAC OFFICES OF REGIONAL OFFICE GANDHINAGAR.
Address of SITE: - 5TH FLOOR LAL DARWAZA BUILDING AHMEDABAD.**

REGIONAL HEAD

REGIONAL OFFICE
GANDHINAGAR ,
Mail ID- gadganaro@centralbank.co.in
Mobile no.- 7607994274

DETAILS OF OUR IEM:

NAME: Shri Trivikram Nath Tiwari
MAIL ID: trivikramnt@yahoo.co.in

NAME: Shri Jagdip Narayan Singh
MAIL ID: Jagadipsingh@yahoo.com
Contact no. 011-61515609, 9978405930

TABLE OF CONTENTS

SR.NO.	PARTICULAR	PAGES
1	NOTICE INVITING TENDER	3
2	ELIGIBILITY CRITERIA	4-6
3	APPENDIX REFERRED TO IN THE GENERAL CONDITIONS	7-8
4	INFORMATION TO BE FURNISHED BY THE APPLICATION	9
5	FORM OF TENDER	10
6	GENERAL INSTRUCTION TO CONTRACTOR	11-14
7	GENERAL CONDITIONS OF CONTRACT	15-26
8	SPECIAL CONDITIONS OF CONTRACT	27-29
9	FORM OF AGREEMENT	30-31
10	SAFETY CODE	32
11	TECHNICAL SPECIFICATIONS FOR CIVIL / FURNITURE WORKS	33-37
12	TECHNICAL SPECIFICATIONS FOR ELECTRICAL WORKS	38-43
13	MODE OF MEASUREMENT	44
12	APPROVED DRAWING (Regional Office and CPAC Offices)	45
13	LIST OF APPROVED MAKES/MATERIALS	46-47

CENTRAL BANK OF INDIA **TENDER NOTICE**

Item wise sealed tenders are invited in 2 bid system for

Renovation, Furniture, Electrical and Data Cabling Work Of Regional Office and

CPAC Offices of Regional Office Gandhinagar

क्षेत्रीय कार्यालय गांधीनगर और सीपेक कार्यालयों के नवीनीकरण, फर्नीचर, विद्युतीकरण और डेटा केबलिंग कार्यों के लिए टु बीड सिस्टम में मदवार मुहरबंद टेंडर आमंत्रित है.

जारीकरण/ Issuance	टेंडर फॉर्म बैंक की वेबसाइट www. Centralbankofindia.co.in पर 07.06.2022 से उपलब्ध होगा. Tender forms will be available on Bank's website www. Centralbankofindia.co.in from 07.06.2022 .
टेंडर जमा करने की अंतिम तारीख/ Last date for submission of the Tenders/	28.06.2022 upto 2.00 PM
टेंडर जमा करने का स्थान/ Place of submission of Tender/	सामान्य प्रशासन विभाग , क्षेत्रीय कार्यालय गांधीनगर , चौथा माला, लाल दरवाजा बिल्डिंग, अहमदाबाद . General Administration Department, Regional Office Gandhinagar , 4th floor, Lal darwaza Building, Ahmedabad.
तकनीकी बोली खुलने की तारीख/ Date of Opening of technical bid	28.06.2022, 4.00 PM
तकनीकी बोली खुलने का स्थान /Place of Opening of technical bid	सामान्य प्रशासन विभाग , क्षेत्रीय कार्यालय गांधीनगर , चौथा माला, लाल दरवाजा बिल्डिंग, अहमदाबाद . General Administration Department, Regional Office Gandhinagar , 4th floor , Lal darwaza Building, Ahmedabad नोट :- ठेकेदारों से अनुरोध है कि टेंडर के खुलने के समय वे उपस्थित रहे. Note: - Vendors are advised to make presence of themselves at the time of opening of tenders.
कार्य की अनुमानित लागत /Estimated cost of work	Rs. 47,39,120.00 (जीएसटी के अतिरिक्त / Excluding GST)
टेंडर फॉर्म का मूल्य /Cost of tender	Rs.2000.00 डीडी के द्वारा, सेंट्रल बैंक आफ इण्डिया, अहमदाबाद के पक्ष में (अप्रतिदेय) Rs.2000.00 In the form of DD in favor of central bank of India Ahmedabad (Non-refundable) एम. एस. एम. ई. पंजीकरण प्रमाणपत्र की फोटोकॉपी संलग्न करने पर एम. एस. एम. ई.

	पंजीकृत ठेकेदारों को छुट दी गयी है/On Attachment of photocopy of MSME registration Certificate, MSME registered vendors are exempted.
बयाना राशी /Earnest Money Deposit	Rs.48,000.00 डीडी के द्वारा, सेंट्रल बैंक आफ इण्डिया, अहमदाबाद के पक्ष में (प्रतिदेय) Rs. 48,000.00 In the form of DD in favor of central bank of India Ahmedabad (Refundable) एम. एस. एम. ई. पंजीकरण प्रमाणपत्र की फोटोकॉपी संलग्न करने पर एम. एस. एम. ई. पंजीकृत ठेकेदारों को छुट दी गयी है/On Attachment of photocopy of MSME registration Certificate, MSME registered vendors are exempted.
Eligibility Criteria/पात्रता शर्तें	<p>1) बिडर कोड कंपनी/निगम/नियाम/ट्रस्ट /रेजिस्टर्ड फ़र्म/भारत में निगमन हो सकता है जो निम्नलिखित पात्रता को पूरा करती हो. पात्रता के संबंधित दस्तावेजी प्रमाणपत्र जमा करना अनिवार्य है. किसी भी रूप में संयुक्त उपक्रम या संघ को अनुमति नहीं है. The bidder can be a company/ corporation/trust/firm registered/ incorporation in India fulfilling the following criteria and must submit documentary evidences. Joint venture or consortium in any form is not allowed.</p> <p>2) बिडर 5 वर्षों से अस्तित्व में होना चाहिए और उसका पंजीकृत कार्यालय गुजरात राज्य में हो. The bidder should be in existence for the last 5 (Five) years and have registered office in Gujarat state.</p> <p>3) पिछले 03 वर्षों के दौरान औसत वित्तीय टर्नओवर, अनुमानित लागत के 30 प्रतिशत के बराबर हो. (कार्य की अनुमानित लागत Rs. 47,39,120.00 जीएसटी के अतिरिक्त है.) Average Annual financial turnover during the last 3 years, ending 31st March of the previous financial year, should be at least 30% of the estimated cost. (Estimated cost of work is Rs. 47,39,120.00 ,Excluding GST)</p> <p>4) बिडर में पिछले माह की समाप्ति तक पाँच वर्षों के दौरान इसी तरह के काम का सफलतापूर्वक समापन करने का अनुभव हो The bidder must have experience of successfully completion of works during last 5 years ending last day of month previous to the one in which bids are invited should be either of the following:</p> <p>4.1) "इसी प्रकार के पूरे किए गए 3 (तीन/three) कार्य जिसकी लागत अनुमानित लागत के 40% से कम न हो /similar 3 work completed works" costing not less than the amount equal to 40% of the estimated cost अथवा/ OR</p> <p>4.2) "इसी प्रकार के पूरे किए गए 2 (दो/Two) कार्य" जिसकी लागत अनुमानित लागत के 50 % से कम न हो/ similar 2 work completed works" costing not less than the amount equal to 50% of the estimated cost अथवा/ OR</p> <p>4.3) "इसी प्रकार के पूरे किए गए (एक/one) कार्य" जिसकी लागत अनुमानित लागत के 80 % से कम न हो "similar 1 work completed work" costing not less than the amount equal to 80% of the estimated cost.</p>

	<p>नोट:</p> <ol style="list-style-type: none"> 1) समान कार्य का मतलब है ऐसे कार्य जिसमे नवीनीकरण,फर्नीचर,विद्युतीकरण और डेटा केबलिंग किए गए हो. 2) उक्त बताए गए कार्यों मे ठेकेदार ने केंद्र/राज्य/औटोनोमस बॉडी/पब्लिक सेक्टर /बैंक /वित्तीय संस्था/शासकीय शिक्षा संस्था मे किया गया हो. <p>Notes:</p> <ol style="list-style-type: none"> I. Similar works mean works including Renovation, furniture, electrical and Data cabling work. II. Out of the above said completed works, the contractor should have completed in Central / State Govt. / Autonomous Body / PSU / Bank / Financial Institutions / Govt. Educational institutes etc. <p>5) वेध पैन, गुड्स एंड सर्विस टैक्स पंजीकरण नंबर हो. Must have valid PAN and GST registration numbers.</p>
<p>टेंडर जमा करने का तरीका /Mode of submission of tender</p>	<p>टेंडर को क्षेत्रीय प्रमुख , सेंट्रल बैंक ऑफ इंडिया,क्षेत्रीय कार्यालय गांधीनगर को संबोधित करते हुए क्षेत्रीय कार्यालय गांधीनगर मे जमा करना है. टेंडर को यहा दिये गए कार्यपद्धती के अनुसार जमा करना है. निर्दिष्ट दस्तावेजो को उपयुक्त साइज़ के लिफाफो मे मोहरबंद किया जाना है.</p> <p>Tender to be addressed to "Regional Head, Central Bank of India, Regional Office, Gandhinagar and should be submitted at Regional Office, Gandhiagar. The tender shall be submitted in accordance to the procedure detailed herein. Specified documents shall be sealed in an envelope of appropriate size.</p> <p>लिफाफा क्रमांक 01- इसमे टेंडर मूल्य और बयाना राशि की डि. डि या विधिवत हस्ताक्षरित एम. एस. एम. ई. पंजीकरण प्रमाणपत्र की फोटोकॉपी, विधिवत हस्ताक्षरित टेंडर पेपर, तकनीकी बोली पत्र, जी एस टी नंबर ,टीन नंबर ,पेन कार्ड ,लोकल एड्रेस प्रूफ , वर्क ऑर्डर की कॉपी , समान कार्य के कंप्लीशन सर्टिफिकेट, और <u>पात्रता शर्तों के संबंधित सारे दस्तावेजी प्रमाणपत्र ,इंटीग्रिटी पेक्ट</u> एवं अन्य जरूरी दस्तावेज होने चाहिए. लिफाफे को मोहरबंद करना है. इस लिफाफे पर तकनीकी बोली लिखना है.</p> <p>Envelope marked no 1 shall contain DD of tender cost and EMD or duly signed photocopy of MSME registration certificate, duly signed tender papers, technical bid, GST no., TIN no., PAN, local address proof. Copy of work orders, completion certificates of similar type of works and all <u>documentary evidence fulfilling eligibility criteria</u> integrity pact and other required documents. This envelope shall be endorsed on the outside face "Technical bid and sealed properly.</p> <p>लिफाफा क्रमांक 02- इसमे विधिवत हस्ताक्षरित वित्तीय बोली रखनी है और मोहरबंद करना है. इस लिफाफे पर वित्तीय बोली लिखना है.</p> <p>Envelope marked no. 2. Shall contain the Price bid. This envelope shall be endorsed on the outside face "Price bid and sealed properly.</p> <p>लिफाफा क्रमांक 03- इसमे लिफाफा क्रमांक 1 और 2 रखना है. इस लिफाफे पर" क्षेत्रीय कार्यालय गांधीनगर और सीपेक कार्यालयों के नवीनीकरण,फर्नीचर,विद्युतीकरण और डेटा केबलिंग कार्यों के लिए टेंडर" लिखना है और वरिष्ठ क्षेत्रीय प्रबंधक, सेंट्रल बैंक ऑफ इंडिया,क्षेत्रीय कार्यालय अहमदाबाद को संबोधित करना है.</p>

	Envelope no. 3. Envelope marked no. 1&2 shall be put in a envelope marked no 3 which shall be properly sealed. This envelope, which shall be endorsed on the outside face. "TENDER FOR RENOVATION, FURNITURE, ELECTRICAL AND DATA CABLING WORK OF REGIONAL OFFICE AND CPAC OFFICES OF REGIONAL OFFICE GANDHINAGAR." and addressed "Regional Head, Central Bank of India, Regional Office, Gandhinagar .
इंटीग्रिटी पेक्ट /Integrity Pact	हर बोलीदाता को दिये गए इंटीग्रिटी पेक्ट विधिवत हस्ताक्षरित करके लिफाफे क्रमांक -1 में जमा करना है. Each participating bidder shall submit duly signed attached Integrity Pact in envelope no1 at the time of submission of bid.
Class-A Electrical Contractor	Contractor has to employ "A" Class Electrical contractor after taking prior approval of the credentials of Electrical contractor, for proposed electrical work as per the tender.
संपर्क अधिकारी /Contact Officer	श्री राजीव रंजन (प्रबंधक)/Mr. Rajeev Ranjan (Manager) Mobile no. 7607994274

- I. बिना टेंडर फीस और ई एम डी की तकनीकी बोली या एम. एस. एम. ई. पंजीकरण प्रमाणपत्र की फोटोकॉपी संलग्न नहीं किए जाने पर की तकनीकी बोली को तत्काल निरस्त कर दिया जायगा.
Technical Bids received without enclosure of tender fee and Earnest Money Deposit or without photocopy of MSME registration certificate will be summarily rejected.
- II. सफल बिडर एम.एस.एम.ई. श्रेणी सहित को फ़ाइनल कोटेड राशी के 2% की बीड सेकुरिटी अकाउंट पेयी डिमांड ड्राफ्ट, फ़िक्स्ड डिपॉजिट, बैंकर चेक या बैंक गैरंटी के रूप में देनी होंगी.
Successful bidder including MSME has to submit bid security of 2% of final quoted amount in the form of account payee Demand Draft, Fixed Deposit Receipt, Banker's Cheque or Bank Guarantee.
- III. पात्रता शर्तों को पूरी करने वाले ठेकेदारों की ही वित्तीय बोली खोली जायगी.
Price bids of the contractor fulfilling eligibility criteria shall be opened.
- IV. नियत समय के पश्चात प्राप्त टेंडरों को स्वीकार नहीं किया जायगा.
Tender received after the last date for submission will not be considered.
- V. बिना सील किए टेंडर को निरस्त किया जायगा.
Unsealed tenders received are liable for rejection.
- VI. यदि बैंक इस टेंडर के बारे में कोई परिशिष्ट, संशोधन, शुद्धिपत्र जारी करता है तो वह इस टेंडर का हिस्सा होगा और उसे बैंक की वेबसाइट पर प्रकाशित किया जायगा. यह बोलीदाता की ज़िम्मेदारी है कि वह हमारे बैंक की वेबसाइट पर जारी किए गए परिशिष्ट, संशोधन, शुद्धिपत्र की जानकारी लेते रहे.
Addendums/Amendments/Corrigendum issued if any to this NIT/ Tender Document shall be part of this tender NIT/Tender Documents and shall be published in our web sites specified above. It is Bidders responsibility to keep themselves updated on any such Addendums/Amendments/Corrigendum published on our Bank's website.

Regional Head / क्षेत्रीय प्रमुख

Regional Office Gandhinagar / क्षेत्रीय कार्यालय गांधीनगर

4th floor, Lal darwaza Building, Ahmedabad/चौथा माला, लाल दरवाजा बिल्डिंग, अहमदाबाद .

<u>APPENDIX REFERRED TO IN THE GENERAL CONDITIONS</u>		
1.	Defects liability period	12 Months from the date of issue of virtual completion and handing over the site to Bank
2.	Date of commencement	Immediate on receipt of work order./ Handing over the site
3.	Date of Completion	45 Days from issue of Letter of intent./Work order/Acceptance of works.
4.	Minimum value of work done for interim payment	Only one interim Bill of 50% of the work Order Value.
5.	Payment Terms	1. No advance 2. Interim Payment 50% - Only one interim bill claim of 50% of the Work Order Value 3. Final Bill settlement within 30 days from the date of proper submission of satisfactory work completion from Civil Engineer and Manager (GAD). All required documents and joint verification of measurements at site.
6.	Security Deposit	Successful bidder including MSME has to submit bid security of 2% of final quoted amount in the form of account payee Demand Draft, Fixed Deposit Receipt, Banker's Cheque or Bank Guarantee.
7.	Retention money for defects liability period	3% of the total value of work.
8.	Liquidated damages for non-completion of work within stipulated period.	0.25% per day subject to maximum of 5% of contract value.
9.	Validity of the Tender	90 days from the last date of opening of the Tender.
10.	Deduction	1. Income Tax at source as per Income Tax Rules Sales Tax /GST/ Works Contract Tax/ Commercial Tax as applicable in the statement. 2. Cess applicable as per the local rules 3. Any other Levy/Cess/Tax to be deducted at source by law.
11.	Period for honouring final payment	30 working days after the submission of the satisfactory work completion from Branch manager and Bank's civil engineer.

12.	Validity of Rates	The quoted Rates in the Tender shall remain valid till the completion of the work. No escalation in rates shall be allowed.
13.	Extra Items	The contractor shall not execute the item for which the rate cannot be derived from the Tender. He shall submit the Rate analysis for such item on actual cost plus 15% as overheads, establishment charge and contractor's profit, and get it approved by Architect/Employer before starting the work of such items.
14.	Measurement	On completion of work all contractor shall give detailed measurements/circuit diagram/List of materials used Test reports duly signed and sealed.
15.	Hidden Items	All hidden measurements must be got checked/ recorded before concealing.
16.	No deviation of material	All material and makes shall be as per specifications any deviation will not be accepted without written permission of Architect/Bank

CONTRACTOR
Seal and signature

Information to be furnished by the Application					
1	Name of the organization				
2	Registered Office details (Submit firm registration certificate)	Registration number		Date of registration	
		Postal Address			
		Telephone Nos.			
		E-mail Address			
3	Financial Strength- Average Annual Turnover & Profit in Rs.		Turnover(Rs.)	Profit(Rs.)	
		FY-2018-19			
	(Submit attested copy of ITR, balance sheet audited & certificate by Chartered Accountant)	FY 2019-20			
		FY 2020-21			
4	Details of similar work executed		Works	Place of work	Amount (Rs.)
	(Submit completion certificate of similar works mentioned in eligibility criteria with details in separate sheet)	1			
		2			
		3			
5	PAN Number (Submit copy of PAN)				
6	GST (Submit copy of PAN)				
7	MSME Registration No.				

Declaration:

I/we hereby submit the information in your prescribed pro-forma and understand that if any information is found to be false at a later date, contract / order made between us and Central Bank of India will be treated as invalid. I/We agree that the decision of Central Bank of India in selection will be final and binding on me/us. All the information furnished in the attached sheets is correct to the best of my/our knowledge. Bank shall have the authority to verify all the information provided by me/us. **All supporting documents shall be provided by me/us in authenticity of the information furnished.** I/We agree that I/We have no objection if inspection of my/our premises/workshop, shop etc. is done by the officials of the Bank.

Date:

Place:

Signature

Name:

Stamp:

FORM OF TENDER

To / प्रती

Regional Head / क्षेत्रीय प्रमुख

Regional Office Gandhinagar/क्षेत्रीय कार्यालय गांधीनगर

Central Bank of India/ सेंट्रल बैंक ऑफ इंडिया

Dear Sir/ आदरणीय श्रीमान

With reference to the tender invited by you for the work. I/We hereby offer to execute the work under contract at the respective rates mentioned in the schedule of quantities.

आपके द्वारा कार्य हेतु आमंत्रित निविदा के संदर्भ में मैं/हम एतद्वारा अनुसूची में उल्लिखित मात्राओं की संबंधित दरों पर अनुबंध के तहत कार्य निष्पादित करने का प्रस्ताव करता हूँ/करते हैं।

I/We have seen the site of 5th floor Lal Darwaza Building understood the general conditions of contract, special conditions, additional conditions.

मैंने/हमने 5 वा माला लाल दरवाजा बिल्डिंग की साइट देखी है, अनुबंध की सामान्य शर्तों, विशेष शर्तों, अतिरिक्त शर्तों को समझ लिया है।

I/We agree to execute the work as per specifications, general conditions of contract, special conditions, and additional conditions.

मैं/हम विनिर्देशों, अनुबंध की सामान्य शर्तों, विशेष शर्तों और अतिरिक्त शर्तों के अनुसार कार्य निष्पादित करने के लिए सहमत हूँ/हैं।

I/we do hereby agree that the sum shall be forfeited by the bank in event our tender is accepted & I/We fail to execute the contract when required to do so.

मैं/हम एतद्वारा सहमत हूँ/हैं कि यदि हमारी निविदा स्वीकार कर ली जाती है और यदि मैं/हम अनुबंध को निष्पादित करने में विफल रहते हैं, ऐसी स्थिति में बैंक द्वारा राशि जब्त कर ली जाएगी।

I/we understand that you are not bound to accept the lowest or any other tender that you received.

मैं/हम जानते हैं कि आप प्राप्त न्यूनतम या किसी अन्य निविदा को स्वीकार करने के लिए बाध्य नहीं हैं।

Yours faithfully/ भवदीय

Signature of contractor / ठेकेदार के हस्ताक्षर

General Instruction to Contractors

Sealed tenders should be address to Regional Head, Central Bank Of India, Regional office, Gandhinagar super scribed Name of work.

“TENDER FOR RENOVATION, FURNITURE, ELECTRICAL AND DATA CABLING WORK OF REGIONAL OFFICE AND CPAC OFFICES OF REGIONAL OFFICE GANDHINAGAR.”

1. No tender will be received after 14.00 Hrs. on Date: 28.06.2022 under any circumstances whatsoever.
2. The contractors are not expected to include any conditions contrary to tender provisions.

MODE OF SUBMISSION OF TENDER: The tender shall be submitted in accordance with the procedure detailed herein.

A. Submission OF Tenders:

Specified documents shall be sealed in two envelopes (Technical & Price bid) of appropriate sizes and envelope should be properly super scribed as:

Envelope no. 1 Technical Bid shall contain: -

- i) DD of Rs.2000.00 as Tender Fee or Photocopy of MSME Registration Certificate
- ii) DD of Rs.48,000.00 as EMD or Photocopy of MSME Registration Certificate
- iii) Supporting documents mentioned in eligibility criteria, other required documents and duly signed **integrity Pact.**

Envelop no. 2; Price Bid shall contain: -

- i) Price Bid duly signed and duly filled in rates and amount in words and figures by the tenderer and should be properly sealed.

B. OPENING OF TENDERS:

The sealed Envelope no. 1 containing the tender fees / EMD /MSME registration certificate (In case) /documents shall be opened in the office of General Administration Department, Regional Office Gandhinagar , 4th floor, Lal Darwaza Building Ahmedabad at 16:00 Hrs. on Dt: 28.06.2022 in presence of Tender Opening Committee and authorized representatives of tenderers.

If the tender fees/earnest money deposit and other information / documents called for are not found as prescribed form/format, the tender shall be rejected. For MSME Contractors, Attachment of MSME Registration Certificate

The tender which is found suitable technically as well as financially whose past performance is found satisfactory to carry out works of similar nature and magnitude as per the details submitted by them and who have fulfilled all other requirements as mentioned in the tender will be considered for opening of Envelop no. 2.

The price bid of rejected tenderers keeping in view the Envelope no. 1 will not be opened and E.M.D. without interest will be returned to them as soon as the bank takes any decision to this effect.

The selected contractors will be intimated by the bank regarding opening of the Envelop no. 2 containing priced tender. The tenderer or his authorized representative who is competent to take on the spot decision in the matter should be present.

[Type text]

After opening the envelope containing the offer on the standardized conditions and opening of the priced tender, no correspondence / revised offer whatsoever may be in nature, will be entertained.

The tender shall remain open for acceptance by the bank for a period of 3 (three) months from the date of opening of the SECOND COVER containing the priced tender which may be extended further by mutual agreement and the tenderer during validity period failing which EMD will be forfeited.

The tenderer must use only the tender forms/documents issued by the Bank. If given space falls short for furnishing the information / separate sheet may be added duly signed by the contractors.

The bank reserves the right to reject or select the tender for opening the priced tender and also the bank will not be bound to accept the lowest tender and reserve the right to accept or reject any or all the tenders without assigning any reason whatsoever.

The time allowed for the completion of work will be 30 Days from the date of issue of work order.

The contractor should quote in figures as well as in words the rate, the amount tendered by them. The amount for each item should be worked out and requisite totals given.

The acceptance of the tenderer will rest with the bank which does not bind itself to accept the lowest tender, and reserves to itself the authority to reject any or all the tenders received without assignment of a reason. All tenders in which any of the prescribed conditions are not fulfilled or are incomplete in any respect are liable to be rejected.

Canvassing in any form with tenders is strictly prohibited and the tender submitted by the contractors who resort to canvassing will be liable to rejection.

An item rate tender containing percentage below / above will be summarily rejected.

On acceptance of the tender, the name of the accredited representative(s) of the contractor who would responsible for taking instructions from the Employer / Architect shall be communicated to the Employer.

Special care should be taken to write the rates in figures as well as in words and the amount in figures only in such a way that interpolation is not possible. the total amount should be written both in figures and in the words. In case of figures, the words "Rs." Should be written before the figures of rupees and word "p" and after the decimal figure, e.g. Rs. 4.15 'p' and in case of words the word 'Rupees' should proceed and the word 'paise' should be written at the end, unless the rate in whole Rupees followed by words only it should invariably be upto two decimal places. While quoting the rate in schedule of quantities, the word 'only' should be written closely following the amount and it should be written in the next line.

The bank does not bind itself to accept the lowest or any tender and reserves to itself the right of accepting the whole or any part of the tender and the tender shall be bound to perform the same at the rate quoted.

No employee of the bank is allowed to work as a contractor for a period of two years of his retirement from bank. This contract is liable to be cancelled if either the contractor or any of his employee is found at any time to be such a person who had not obtained the permission of the bank, as aforesaid before submission of the tender or engagement in the contractor's service.

The tender shall not be witnessed by a contractor or contractor who himself / themselves has / have tendered for the same work. Figure to observe this condition would render tender of the contractor tendering as well as witnessing the tender the tender liable to summary rejection.

It will be obligatory on the part of the tenderer to sign the tender documents for all the component parts and that, after the work is award, he will have to enter in to an agreement for each component with the competent authority in the bank.

[Type text]

Prices quoted by the tenderer should include all taxes, local taxes, octroi, sales tax, excise duty, sales tax on work contract etc. materials, labour, delivery, installation charges etc. but **excluding GST**. No extra will be paid on any account.

Prices quoted by the tenderer shall remain firm during execution of the work and no escalation on quoted rates shall be entertained on account of variation in the prices of raw materials, labour, taxes and any Government levies etc.

Sales tax or any other tax on material or on finished work like work's contract tax, turn over tax etc. in respect of this contract shall be payable by the contractor and the bank will not entertain any claim what so ever in this respect.

The Contractor has to supply and adhere to the specific makes and specifications of all the items, which are mentioned in the tender.

The contractors would use all the materials for various items strictly as per enclosed list of approved brands and makes and he should justify the purchase of all the materials to the Architect's and Bank's Engineer's satisfaction.

All quantities indicated in tender are approximate & are likely to change. Contractor must take actual measurement at site, before starting the work.

Billing to be done as per actual measurement of work done at site. Measurement of work should be taken as per I.S. 1200.

The contractor is instructed of get approval of all the material, fixtures, color and shade before starting the work. If required, he should provide different sample of materials for approval, before execution of work. Contractor is strictly instructed to get it approved the Samples of each and every item before putting the finishing material on it.

No changes in the design should be done without any discussion with the Architect and for any clarification, the architects may be contacted.

Rates quoted in tender should be inclusive of all taxes, transportation, loading/unloading, stacking, safe keeping etc. but **EXCLUDING GST**.

Work has to be got executed at site in co-ordination with various other agencies.

Some of the above items may not be operated at all. It will be Bank's discretion. Contractor cannot claim any charges/compensation for non-operation of any items.

In case the supplier found using substandard material or non-specified product or not giving top class quality of finish, serious action will be taken including rejection of the entire furniture.

If the tenderer has a relative employed in any capacity with the Bank, he shall inform the authority calling the tenders of the fact when submitting his tender.

No addition of extra work outside the contract, however patty, may be carried out except under in accordance with a duly executed agreement or on a special written authority from duly authorized officer of the Employer.

No agreement is valid unless signed by the contractor or his duly authorized agent and by a competent person on behalf of the employer.

[Type text]

Tender, invitation to tender, form of tender, instruction to tenderers, General condition of contract, special condition contract, agreement, specification, Drawings, Time schedules, and the rates and the amount quoted against the item of the tender schedule together with the letter of Intent awarding the work shall from the contract. if there is any conflict between any of provisions in the special conditions and any of other documents refund, the provision in the special conditions of contract shall prevail.

Similarity, if there be any difference between the description in the specification and drawings and works item in the schedule of quantities, the description in the schedule of quantities shall prevail.

Signature of Contractor & Seal.

GENERAL CONDITIONS OF CONTRACT

1. Each Tenderer must before submitting his tender, visit the site of works so as to ascertain the physical site conditions, availability and quality of materials according to Specifications before submitting the quotations.
2. The Contractor shall inspect and examine the site and its surrounding and shall satisfy himself before submitting his tender as to the form and nature of the site, the quantities and nature of access to the site, all type of risks, contingencies and other circumstances which may influence or affect his tender.
3. The successful tenderer will not be entitled to any claim of compensation for difficulties faced or losses incurred on account of any site condition which existed before the commencement of the work or which in the opinion of the Bank might be deemed to have reasonably been inferred to be so existing before commencement of work.
4. The Contractor have to satisfied himself before tendering as to the correctness and sufficiency of his tender for the works and of the rates and prices quoted in the Schedule of work/items/quantities / Bills of Quantities, which rates and prices shall cover all his obligations under the Contract and all matters and things necessary for proper completion and maintenance of the works. No extra charges consequent on any misunderstanding or otherwise shall be allowed.
5. Prices quoted by the tenderer should include all taxes, local taxes, octroi, sales tax, excise duty, sales tax on work contract etc. materials, labour, fluctuation of rates, delivery, installation charges etc. but **EXCLUDING GST**. no extra will be paid on any account.
6. **Quoted rates shall be exclusive of GST.**
7. Rates quoted in tender should be inclusive of scaffoldings, tools & plants, transportation, loading/unloading, stacking, safe keeping etc. or any other expenditure for carrying out the work.
8. No escalation in rates will be allowed under any circumstances.
9. Joint tenders shall not be considered.
10. Conditional tenders quoted by the tender is liable to be rejected.
11. The Bank reserves the right to rejected any or all the tenders, accept part of any tender or entrust the entire work to any contractor or divide the work to more than one contractor (item wise) without assigning any reason or giving any explanation. The rates quoted by the contractor will hold good for this bifurcation and no compensation will be paid on this account.
12. The tenders will remain valid for a period of 6 months from the date of opening of tenders, Bank reserves the right to accept or reject any or all the tenders without assigning any reason to do so. Bank does not bind itself for accepting the lowest tender.
13. All items of work described in the schedule of quantities are paid only after completion of that work in all respects and as per given specifications.
14. The work is to be executed in accordance with the specifications, schedule of quantities, drawings, and any further instructions/drawings, which may be given by the Bank during the execution of work. All drawings related to the work given to the contractor together with a copy of schedule of quantities/BOQ are to be kept at site and the Bank shall be given access to such drawings of schedule of quantities/BOQ

whenever necessary. In case any detailed drawings are necessary contractor shall prepare such detailed drawings with dimensional sketches therefore and have it confirmed by the Bank prior to talking up such work. The contractor shall ask in writing for all clarifications/approvals on issues arising anywhere in drawings, specifications and schedule of quantities or to additional instruction at least 1 week ahead from the time for execution.

15. Bank has right to omit any of items of schedule of rates. It will be Bank's discretion. Contractor cannot claim any charges/compensation for non-operation of any items.
16. **TENDERS:** The entire set of tender paper issued to the tenderer should be submitted fully priced and also signed on the last page together with initials on every page. Initial / signature will indicate the acceptance of the tender papers by the tenderer. The schedule of quantities shall be filled in as follows:
 - i) The "Rate" column to be legibly filled using ink/Ball pen both in English figures and English words.
 - ii) Amount column to be filled in for each item and the amount for each sub head as detailed in the "Schedule of Quantities".
 - iii) All corrections are to be initialed.
 - iv) In case of any errors / omissions in the quoted rates, the rates given in the tender marked "original" shall be taken as correct rates.

No modifications, writings or corrections can be made in the tender papers by the tenderer.

The Bank reserves the right to reject the lowest or any tender and also to discharge any or all of the tenders of each section or to split up and distribute any item of work to any specialist firm or firms, without assigning reasons.

The tenderers should note that the tender is strictly on the item rate basis and their attention is drawn to the fact that the rates for each and every item should be correct, workable and self-supporting. If called upon by the Bank detailed analysis of any or all the rates shall be submitted. The Bank shall not be bound to recognize/accept the contractor's analysis.

The works will be paid for as "measured work" on the basis of authorized actual work done and not as "lump sum" contract, unless otherwise specified.

All items of work described in the schedule of quantities are to be deemed and paid as complete works in all respects and details including preparatory and finishing works involved, directly related to and reasonably detectable from the drawings, specifications and schedule of quantities and no further extra charges will be allowed in this connection. In the case of lump-sum charges in the tender in respect of any items of work will be made for the actual work done on the basis of lump sum charges as will be assessed to be payable by the Bank.

The Bank has power to add to, omit from any work as shown in drawings or described in specifications or include in schedule of quantities and intimate the same in writing but no addition, omission or variation shall be made by the contractor without authorization from the Bank. No variation shall vitiate the contract. The tenderer shall note that his tender shall remain open for consideration for a period of six months from the date of opening of the tender (PriceBid).

17. **EXTRA ITEMS:** The Contractor shall not commence work in respect of any extra items/deviations without obtaining the approval of the Bank in writing. The Contractor shall instantly submit the rate analysis for such items with necessary details to support the rate quoted. The rate shall then be settled by the Bank and necessary certificate based on this shall be given to Bank while incorporating the item in the Bill. The rates will be worked out on actual cost of material and labour, any other expenditure for completing that work plus 15% towards contractor's profit & overheads. For this contractor must submit the rate analysis supported by original vouchers for purchase and labor.

18. The successful tenderer is bound to carry out items of work necessary for completion of job even though the same are not included in the schedule of quantity. Rates of extra items will be derived from the tender. In case the rates do not exist in the tender and extra item is not similar to tender item, then the rates will be worked out as mentioned above.
19. **VARIATION IN SCHEDULE OF QUANTITIES** - Variation in tender quantities in this tender are subject to any variation by way of addition, reduction or deletions of the items or quantities. No compensation whatsoever will be paid for such variations.
20. **AGREEMENT:** The successful contractor will be required to sign agreement in accordance with the draft agreement form enclosed and the schedule conditions. The contractor shall pay for all stamps and legal expenses, incidental thereto. However the written acceptance by the employer of a tender will constitute a binding contract between the employer and the person so tendering whether such formal agreement is or is not subsequently executed.
21. **PERMITS AND LICENSE:** The contractor will arrange permits and license for materials whenever/wherever required at his own cost.
22. **GOVERNMENT AND LOCAL RULES:** The contractor shall conform to the provision of all-local-by-laws and acts relating to the work and to the regulations etc., of the government and local authorities and of any company with whose system the structure is propose to be connected. The contractor shall give all notices required by said act, rules, regulations and by-laws etc., and pay all fees payable to such authority / authorities for execution of the work involved. The cost, if any, shall be deemed to have been included in his quoted rates, taking in to account all liabilities for license, fees for footpath encroachment and restorations etc. and shall indemnify the Bank against liabilities and shall defend all actions arising form such claims or liabilities.
23. The contractor must co-operate with other contractors appointed by the Bank so that entire work shall proceed smoothly with least possible delay and to the satisfaction of the Bank.
24. **EARNEST MONEY DEPOSIT**-The Contractor will have to deposit an amount of Rs. 48000.00 in the form of bank draft in favor of Central Bank of India, payable at Ahmedabad at the time of submission of tender as earnest money. The employer is not liable to pay interest on earnest money. For MSME contractor attachment of photocopy of MSME registration certificate is mandatory.

All unsuccessful tenders will be returned without any interest soon after the decision to award work is taken or after the expiry of the validity period of the tender.
25. **SECURITY DEPOSIT** -The successful Tenderer including MSME category to whom the Contract is awarded shall deposit as initial security deposit by Demand draft, fixed deposit receipt, Bankers Cheque or Bank Guarantee a sum to make up 2% of the value of the accepted tender. In case of Non MEME contractor 2% security deposit shall be after the appropriation of the Earnest Money deposited by him.

The successful Tenderer shall pay security deposit within Ten days after receiving the letter of acceptance of his tender. No interest shall be paid on this security deposit.

The security deposit, either in whole or in part thereof, shall be forfeited in the event of the Contractor's failure to observe any terms of this Contract/or non-compliance with the conditions of the Contract.
26. **TOTAL RETENTION MONEY** –Total 3% (including 2% security deposit) value of work done shall be deducted as retention money during payment of bill. Retention amount will be released upon completion of defect liability period of 12 months starting from the date of Virtual Completion of work and after adjusting all dues if any from the contractor.

Date of virtual Completion is the date when awarded work is sufficiently completed to the satisfaction of Bank and suitable for occupying and also as per terms & conditions mentioned in the tender.

27. **ACCESS TO WORKS:** The Bank and any person authorised shall at all reasonable times have free access to the works and to the workshops, Factories or other places where materials are being prepared or constructed for the Contract and also to any place where the materials are lying or from which they are being obtained. The Contractor shall give every facility to the Bank and their representatives for inspection and examination and test of the materials and workmanship. Contractor shall provide everything necessary to access the quality of work. Contractor shall provide everything necessary (measuring tape, ladder, platform etc.) to access the measurement and quality of works.
28. **CONTRACTOR TO PROVIDE ALL EVERYTHING NECESSARY FOR WORKS:** The contractor shall supply, fix and maintain at his own cost, for the execution of any work, all tools, tackles, machinery's and equipment's and all the necessary centering, scaffolding, staging, planking, timbering, stuffing, shoring, pumping, fencing, boarding, watching and lighting by night as well as by day required not only for the proper execution and protection of the said work but also for the protection of the said work but also for the protection of the public and safety of any adjacent roads, streets, wards, houses, buildings all other erections, matters and things and the contractor shall take down and remove any or all such centering, scaffolding, planking, timbering, strutting, shorting etc., as occasions shall be required or when ordered so to do, and shall fully reinstate and make good all matters and thing disturbed during the execution of works to the satisfaction of the employer/architects.
29. The contractor shall at all times given access to workers employed by the Bank or any authorised employed on the buildings and to provide such parties with proper sufficient and if required, special scaffolding, hoists and ladders and provide them with water and lighting and leave or make any, holes, grooves etc. in any work where directed by the Bank as may be required to enable such workmen to lay or fix pipes, electrical wiring, special fitting. The quoted rates of the tenders shall accordingly include all these above-mentioned contingent works.
30. **TIME OF COMPLETION:.** Time for completion of works shall be one month after hand over of site. The entire work is to be completed in all respects within the stipulated period. The work shall be commenced within seventh day from the date of handover of site. Contractor has to strictly adhere with the timeline of tender.
31. **LIQUIDATED DAMAGES:** The successful tenderer is bound to carry out entire work within the period stipulated in the Appendix. The tenderer will have to pay liquidated damages for non-completion of job within stipulated period at the rate of 0.25% per day after expiry of period of completion subject to maximum of 5% of the contract value.

The liquidated damages as mentioned above may not be enforced if the contractor applies sufficiently in advance for extension of time mentioning the unavoidable reasons for extension. The Bank shall, if in its opinion (which shall be final and binding upon the contractor) finds genuine reasons shown by the contractor for such request, grant suitable extension in time limit. Any claim for damage or compensation in relation there to by contractor is not permissible. Also other terms and conditions of the contract will remain unaltered in the extended period.

32. **MATERIALS, WORKMANSHIP, SAMPLES, TESTING OF MATERIALS:** All the works mentioned in the tender or approved extra items are required to be executed in the best and most workmanship manner with materials of the best and approved quality of the respective kinds in accordance with at the particular BOQ specifications, methods/specifications/applications given by manufacturer, instructions and per drawings or as per Bank's instructions during the execution of the work and to Bank's entire satisfaction.

If required by the Bank, the contractor shall have to carry out tests on materials and workmanship at site and at approved materials testing laboratories or as prescribed by the Bank at his own cost to prove that material etc., under test conform to the relevant I.S. Standards or as specified in the specifications.

The work must be done in the best workmanship manner. Samples of all materials to be used must be submitted to the Bank and written approval to be obtained from Bank prior to its application at site.

33. **REMOVAL OF IMPROPER WORK:** The Bank shall during the progress of the work have power to order in writing from time to time the removal from the work within such reasonable time or times as may be specified in the order of any materials which in the opinion of the Bank are not in accordance with specification or instructions, the substitution or proper re-execution of any work executed with materials or workmanship not in accordance with the drawings and specifications or instructions. In case the contractor refuses to comply with the order the Employer shall have the power to employ and pay other agencies to carry out the work and all expenses consequent.

The work is liable to be technically examined and audited by the Bank/ Chief Technical Examiner of Central Vigilance Commission, Govt. of India from time to time. Any defects/improvements or testing etc. pointed out by the Bank/ Chief Technical Examiner/ Technical Examiner should have to be carried out by the contractor at his own cost and any deductions suggested by the Bank/CTE/ TE will be affected from the amount payable to the contractor or from his security deposit etc.

34. **CONTRACTOR'S EMPLOYEES:** The contractor shall employ technically qualified and competent supervisors for the work shall be available (by turn) throughout the working hours to receive and comply with instructions of the Bank. The contractor shall engage at least one experienced engineer as site in charge for execution of the work.

The contractor shall employ local laborers on the work as far as possible. No labourer below the age of sixteen years and who is not an Indian shall be employed on the work.

The contractor shall comply with the provisions of all labour legislation including the requirements of

- (a) The payment of wages act.
- (b) Employer's liability act.
- (c) Workmen's compensation act.
- (d) Contract labour (regulation & abolition) act, 1970 and central rules 1971.
- (e) Apprentices act. 1961.
- (f) Any other act or enactment relating thereto and rules framed hereunder from time to time.

The contractor shall keep the employer saved harmless and indemnified against claims if any of the workmen and all costs and expenses as may be incurred by the employer in connection with any claim that may be made by employed workmen. The contractor shall comply at his own cost with the order of requirement of any health officer or any local authority or the Bank. Contractor shall provide facilities for pure drinking water, sanitation, first aid at all times for the use of men engaged on the works and shall remove and clear away the same on completion of the works.

35. **DISMISSAL OF WORKMEN:** The contractor shall immediately dismiss from works any person employed thereon by him on the request of the Bank. Who may in opinion of the Bank is unsuitable or incompetent or who may misconduct himself. Such discharge shall not be the basis of any claim for compensation or damages against the employer or any of their chief officer or employee.
36. **ASSIGNMENT:** The contractor shall execute the all the works included in the contract. Contractor shall not directly or indirectly transfer, assign or underwrite the contract or its any part.
37. **DAMAGE TO PERSONS AND PROPERTY INSURANCE ETC.** The contractor shall be responsible for all injury to the work or workmen to persons, animals or things and for all damages to

the structural and/or decorative part of property which may arise from the operations or neglect of himself or of any sub-contractor or of any of his or a sub-contractor,,s employees, whether such injury or damage arise from carelessness, accident or any other cause whatsoever in any way connected with the carrying out of this contract. The clause shall be held to include inter-alia, any damage to buildings whether immediately adjacent or otherwise, and any damage to roads, streets, foot paths or ways as well as damages caused to the buildings and the works forming the subject of this contract by rain, wind or other inclemency of the weather. The contractor shall indemnify the Bank and hold harmless in respect of all and any expenses arising from any such injury or damages to the person or property as aforesaid and also in respect of any claim made in respect of injury of damage under any acts on compensation or damage consequent upon such claim. The contractor shall reinstate all damages of every sort mentioned in this clause so as to deliver the whole of the contract works complete and perfect in every respect and so as to make good or otherwise satisfy all claims for damages to the property of third parties. The contractor shall affect the insurance necessary and indemnify the Employer entirely from all responsibility in this respect. The insurance must be placed with a company approved by the Bank and must be effected jointly in the name of the contractor and Bank and the policy lodged with the letter. The scope of insurance is to include damage or loss to the contract itself till this is made over in a complete state. Insurance is compulsory and must be affected from the very initial stage. The contractor shall also be responsible for any thing which may be excluded from damage to any property arising out of incidents, negligence or defective carrying out of this contract. The Bank shall be at liberty and is hereby empowered to deduct the amount of any damages, compensations, costs, charges and expenses arising or accruing from or in respect of any such claim or damages from any sums due or to become due to the contractor.

38. **INSURANCE:** Unless otherwise instructed the contractor shall insure the works and keep them insured until the virtual completion of the contract against loss or damage by fire and earthquake, flood, wars, storms etc. The insurance must be placed with a company approved by the Bank, in the joint names of the Bank and the contractor (the name of former being placed first in the policy) for full amount of contract and for any further sum if called to do so by the Bank, the premium of such being allowed to the contractor as an authorized extra. The contractor shall deposit the policy and receipt for premiums paid with the Bank within 21(twenty one) days from the date of issue of work order unless otherwise instructed. In default of the contractor insuring as provided above, the Bank on his behalf may so insure and may deduct the premiums paid from any money due, or which may become due to the contractor. The contractor shall as soon as the claim under the policy is settled or the work reinstated by the Insurance Company should they elect to do so, proceed with due diligence with the completion of the works in the same manner as though the fire has not occurred and in all respects under the conditions of the contract. The contractor in case of rebinding or reinstatement after fire shall be entitled to extension of time for completion as the Bank may deem fit.
39. **ACCOUNTS RECEIPTS & VOUCHERS:** The contractor shall, upon the request of the Bank furnish them with all the invoices, accounts, receipts and other vouchers that they may require in connection with the works under this contract. In case of any discrepancies, the decision of the Bank shall be final and binding on the contractor.
40. **MEASUREMENTS:** Before taking any measurement of any work the Bank's Engineer or a subordinate deputed by him shall give reasonable notice to the contractor. If the contractor fails to attend at the measurements after such notice or fails to countersign or to record the difference within a week from the date of measurement in the manner required by the Bank's Engineer then in any such event the measurements taken by the Bank's Engineer or by the subordinate deputed by him as the case may be is final and binding on the contractor and contractor shall have no right to dispute the same.
41. **PAYMENTS:** All bills shall be prepared by the contractor in the form prescribed by the Employer/Architects. One interim bill shall be prepared beyond 50% work completion. The interim bill claim of 50% of the Work Order Value in proper forms must be duly accompanied by detailed measurements in support of the quantities or work done and must show deductions for all previous payments, etc., It is deemed that the vendor has agreed to the deduction of 5% from the 'Interim

Payment' towards the 'Retention money, which will be returned as per the relevant Clauses in the agreement. All bills shall be prepared by the contractor in the form prescribed by the Bank. The Bank's Engineer shall issue a certificate after due scrutiny of the contractor's bill stating the amount due to the contractor from the Bank and the contractor shall be entitled to payment thereof, within the period of honoring certificates named in these documents.

The amount stated in an interim certificate shall be the total value of works which is properly completed and executed as per specifications and upto Bank's satisfaction. Any items which are under progress shall not consider in the Bills. The Bank will deduct retention money of these conditions. The refund of retention money will be made as after completion of defect liability period. If the Bank has supplied any materials or goods to the contractor, the cost of any such materials or goods will be progressively deducted from the amount due to the contractor in accordance with the quantities consumed in the work. All the interim payments shall be regarded as payments by way of advance against the final payment only and not as payments for work actually done and completed, and shall not preclude the requiring of bad, unsound, and imperfect or unskilled work to be removal and taken away and reconstructed, or re-erected or be considered as and admission of the due performance of the contract, or any part thereof in any respect or the accruing of any claim, nor shall, it conclude, determine or affect in any way the power of the Bank under these conditions or any of them as to the final settlement and adjustment of the accounts or otherwise or in any other way vary or affect the contract. The final bill shall be submitted by the contractor within one month of the date fixed for completion of the work or of the date of certificate of completion furnished by the Architect/Bank and payment shall be made within three months. No mobilization advance or secured advance on materials or any other advance will be granted by the Bank.

42. **FINAL PAYMENT:** The final bill shall be accompanied by a certificate of completion from the Bank. Payments of final bill shall be made after deduction of Retention Money, which sum shall be refunded after the completion of the Defects Liability Period after receiving the Bank's user department certificate that the contractor has rectified all defects to the satisfaction of the Bank. All payments, interim bills already made to the contractor shall also deduct in the final payment. The acceptance of the payment of the final bill by the contractor would indicate that he will have no further claim in respect of the work executed. The employer shall have a right to cause technical examination and audit of the works and the final bill of the contractor including all supporting vouchers, abstracts, etc., to be made at the time of payment of final bill. If as a result of this examination or otherwise any sum is found to have been overpaid or over certified, it shall be lawful for the employer to recover the same from the contractor from any sum due to him.
43. In case, after completion of the work and final payment to the contractor, it is found on account of General Audit, Technical audit and or any other reason whatsoever that any amount is recoverable from the contractor, it shall be lawful for the employer, to recover the same from any sum whatsoever payable by the Bank to the contractor either in respect of this contract or any other contract or on any other account by any other branch/department of the employer.
44. **SITE MEETINGS:** Site meetings will be held to review the progress and quality evaluation. The contractor shall depute a senior representative alongwith the site representative and other staff of approved sub-contractors and suppliers as required to the site meetings and ensure all follow up actions. Any additional review meetings shall be held if required by the architect/ consultant.
45. **SUBSTITUTION:** Substitution should be contractor desire to substitute any materials and workmanship, he/they must obtain the approval of the Bank in writing for any such substitution well in advance. Materials designated in this specification indefinitely by such term as "Equal" or "Other approved" etc. specific approval of the Bank as to be obtained in writing. Decision of the Bank will be final.
46. **PREPARATION OF OFFICE SPACE FOR OCCUPATION AND USE ON COMPLETION:** The whole of the work will be thoroughly inspected by the contractor himself and deficiencies and defects

put right. On completion of contractor's inspection, the contractor shall inform the Bank that the he has completed the work and it is ready for inspection by the Bank.

47. **CLEARING SITE ON COMPLETION:** On completion of the works the contractor shall clear away and remove from the site all tools & plant, surplus materials, rubbish and temporary works of every kind and leave the whole of the site and the works clean and in a workmanlike condition to the satisfaction of the Bank. The rate quoted by the contractor shall include all such contingencies. On completion the contractor shall clean all windows and doors including the cleaning and oiling if necessary, of all hardware, inside and outside, all floors, stair-cases, and every part of the building. He will leave the entire building neat and clean and ready for immediate occupation and to the satisfaction of the Bank.
48. In Between execution of works, if it is found by the Bank that dumped material are making difficulties in movement of public, then contractor has to remove/shift that material from that place immediately.
49. **DEFECTS AFTER COMPLETION:** The contractor shall make good at this own cost and to the satisfaction of the Bank all defects, shrinkage, settlements or other faults which may appear within 12 months after completion of the work- In default the Bank may employ and pay other persons to amend and make good such damages, losses and expenses consequent thereon or incidental thereto shall be made good and borne by the contractor and such damages, loss and expenses shall be recoverable from Contractor by the Bank .
50. **CONCEALED WORK:** The contractor shall give due notice to the Bank whenever any work is to be buried in the earth, enclosed or in the bodies of walls/partition or otherwise becoming in accessible later on, in order that the work may be inspected and correct dimensions taken before such burial, in default where of the same shall, at the opinion of the Bank be either opened up for measurement at the contractor's expenses or no payment may be made for such materials Should any dispute or differences arise after the execution of any work as to measurements etc. or other matters which cannot be conveniently tested or checked the notes of the employer/ architects shall be accepted as correct and binding on the contractor.
51. **ESCALATION:** The rate quoted shall be firm throughout the tenure of the contract including extension of time, if any, granted and will not be subject to any fluctuation due to increase in cost or materials, labour, sales tax, octroi, etc. (EXCLUDING GST).
52. **SIGNING OF TENDER:** The tender shall contain the name residence and place of business of person or person making the tender and shall be signed by the contractor with his usual signature. Partnership firms shall furnish the full name of all partners in the tender. It should be signed in the partnership name by all partners or by duly authorized representative followed by corporation shall be signed by an authorized representative, and in power of Attorney in that behalf shall accompany the tender. A copy of constitution of the firm with names of all partners shall be furnished.
53. **TRANSFER OF TENDER DOCUMENTS:** Transfer of tender documents purchased by one intending contractor to another is not permitted.
54. **SPECIAL CONDITIONS OF CONTRACT:** Special condition of contract shall be read in construction with the general conditions of contract, specifications of work, Drawings and any other documents formed part of this contract where the context so required. Notwithstanding the sub-division of the documents into these separate sections and volumes every part of each shall be deemed to be supplementary to the complementary of every other part and shall be read with and into the contract so far as it may be practicable to do so. Where any portion of the General Conditions of Contract it repugnant to or at variance with any provisions of the Special Conditions of Contract, then unless a

different intention appears, the provisions of the special conditions of contract shall be deemed to override the provisions of the General Conditions of Contract and shall, to the extent of such repugnancy of variations.

55. **RIGHTS OF BANK TO FORFEIT SECURITY DEPOSIT:** Whenever any claim against the Contractor for the payment of a sum of money arises out of or under the contract, Bank shall be entitled to recovery such sum by appropriating in part or whole, the security deposit of the contractor, and to sell Government securities, etc. forming whole or part of such security. In the event of the security being insufficient or if no security has been taken from the Contractor, then the balance or the total sum recoverable, as the case may be, shall be deducted from any sum then due or which at any time there after any become due to the Contractor under this or any other contract with the Bank and should this be not sufficient to cover the recoverable amount the contractor remaining due.
56. **ACTION WHEN WHOLE OF SECURITY DEPOSIT IS FORFEITED:** In any case in which under any clause or clauses of this contract the contractor shall have forfeited the whole of his security deposit (whether paid in one sum or deducted by installments) or have committed a breach of any of the terms contained in this contract Employer shall have power to adopt any of the following courses as they deem best suited to its interest.
- a. To rescind the contract of which rescission notice in writing to the contractor under the hand of the Site Engineer shall be conclusive evidence in which case the security deposit of the contractor shall stand forfeited and be absolutely at the disposal of Bank.
 - b. To employee labour paid by Bank and to supply material to carry out the work or any part of the work debiting contractor with the cost of labour and the price of the materials of the amount of which cost and price, a certificate of the Bank's Civil Engineer shall final and conclusion against the contractor, and credit by him with the value of the work done, in all respect and same manner and at the same rates as if it had of carried out by the contractor under the terms of his contract. The certificate of the Bank's Civil Engineer to the value of the work done shall be final and inclusive against the contractor.
 - c. Unexecuted jobs to give is to another contractor to complete, which case may expenses which may be incurred in excess the sum which would have been paid to the original contractor had the work been executed by him shall borne and paid by the original contractor and may deducted from any money due to him otherwise or from his security deposit or retention money or from the proceeds of sale thereof, or a sufficient thereof.
57. The event of any of the above course being adopted by the Bank, the contractor shall have no claim compensation for any loss sustained by him be reason his having purchased or procured any material or bear on to any advances on account of or with a view the execution of the work or the performance of the contract.
58. **EXECUTION OF WORKS:** All the works shall be executed in strictly as per the provisions of the contract and according to detailed drawings, specifications and instructions as may be furnished from time to time to contractor by the Bank whether mentioned in the contract or not. The contractor shall be responsible for ensuring that works are executed in the most substantial proper workmanship in strictly as per specifications and to the satisfaction of the Bank. Wherever it is mentioned in the specifications that the contractor shall perform certain work or provide certain facilities/ materials, it is understood that the contractor shall do so at his cost. The materials, design and workmanship shall satisfy the relevant Indian Standards, the job specifications contained herein and codes referred to. In case certain jobs are not having any Indian Codes, that job shall be executed according to instruction and Bank's satisfaction.
59. **SCHEDULE OF RATE TO COVER CONSTRUCTIONAL PLANT, MATERIALS, LABOUR, ETC.**

Rates quoted by the contractor shall include and cover the cost of all constructional plant, temporary works (except as provided for herein) pumps, materials, labour, insurance, fuel, stores, etc.

60. **SCHEDULE OF RATES TO COVER ROYALTIES, RENTS AND CLAIMS:** Quoted rates shall include the cost of all royalties and fees for all articles, processes, protected by letters, patent or otherwise incorporated in or used in connection with the works, also all royalties, rents and other payments in connection with obtaining materials of whatsoever kind for the works and shall include an indemnity to Bank which the contractor hereby give against all actions, proceedings, claims, damages, costs and expenses arising from the incorporation or the use on the works of any such articles, processes or materials Octroi or other municipal or local Board charge, if levied on materials, equipment or machinery's to be brought to site and removed form site for use on work or after completion of the work, shall be borne by the contractor.
61. **PROCEDURE FOR MEASUREMENT & BILLING OF WORK IN PROGRESS MEASUREMENTS:** All measurements shall be as unit mentioned in the Price Bid. All the works executed at site shall be recorded in the measurement book/sheet by the contractor. For the purpose of taking joint measurement the contractor's representative shall be bound to be present whenever required by the Site Engineer. Bank's Civil Engineer or his representative will take measurements and this will be deemed to be correct, and binding on the contractor. Works that are likely to be covered up by subsequent operations should be got measure before such covering up, failing which such covered works may be liable for not being measured.
62. **BILLING:** The contractor will submit a bill in approved Performa in triplicates to the Bank alongwith detailed measurement for the various items executed during a month.
63. **DISPUTE ABOUT MODE OF MEASUREMENT:** In case of any dispute, mode of measurement as per Indian Standard Specification No. 1200 shall be followed.
64. **RECEIPT FOR PAYMENT:** Receipts for payments made on account of executed work, must be signed by a person holding due power of attorney in this respect on behalf of the contractor, except when the contractor is described in his tender as a limited company in which case the receipts must be signed in the name of the company by one of its Principal officers or by some other persons having authority to give effectual receipt for the company. The Bank shall have the right to cause a technical examination of the works and final bill of contractor including all supporting vouchers, abstracts, etc., to be made at the time of payment of the final bill. If is a result of this examination or otherwise any sum found to have been overpaid or over certified, it shall be lawful for the Bank to recover the sum.
65. In case, after completion of the work and final payment to the contractor, it is found on account of General Audit, Technical audit and or any other reason whatsoever that any amount is recoverable from the contractor, it shall be lawful for the employer, to recover the same from any sum whatsoever payable by the employer to the contractor either in respect of this contract or any other contractor on any other account by any other branch/department of the Bank.
66. **PHOTOGRAPHS:** The Contractor shall at his own expense supply to the Architects with duplicate hard copies of large photographs not less than 25 cm. x 20 cm. (10" x 8") of the works, taken from two approved portions of each building, at intervals of not more than one months during the progress of the work or at every important stage of construction. In addition to above, the contractor shall be bound to submit adequate no. of site photographs alongwith each Bill for the project clearing showing major progress of work measured and claimed therein failing which the Bank may consider returning the Bill to the contractor and no claim for delay on this account will be entertained.
67. **SUSPENSION:** If the contractor except on account of any legal restraint upon the Bank preventing the continuance of the work or in the opinion of the Bank shall neglect or fail to proceed with due diligence in the performance of his part of the contract or if he shall more than once make default, the Bank shall have the power to give notice in writing to the contractor requiring the work to be proceeded with in a

reasonable manner and with reasonable dispatch, such notice purport to be a notice under this clause. After such notice shall have been given the contractor shall not be at liberty to remove from the site of the works or from any ground contiguous thereto any plant or materials to subsist from the date of such notice being given until the notice shall have been complied with. If the contractor fails to start the work within seven days after such notice has been given to proceed with the works as therein prescribed, the Bank may proceed as provided in Termination of Contract by Employer clause.

68. **TERMINATION OF CONTRACT BY EMPLOYER:** If the contractor being a company go into liquidation whether voluntary or compulsory or being a firm shall be dissolved or being an individual shall be adjudicated insolvent or shall make an assignment or a composition for the benefit of the greater part, in number of amount of his creditors or shall enter into a Deed or arrangement with his creditors, or if the Official Assignee in insolvency, or the Receiver of the contractor in insolvency, shall repudiate the contract, or if a receiver of the contractor's firm appointed by the court shall be unable within fourteen days after notice to him requiring him to do so, to show to the reasonable satisfaction of the Bank that he is able to carry out and fulfill the contract, and if so required by the employer to give reasonable security therefore, or if the contractor shall suffer execution to be issued, or shall suffer any payment under this contract to be attached by or on behalf of and of the creditors of the contractor, or shall assign, charge or encumber this contract or any payments due or which may become due to contractor, there under, or shall neglect or fail to observe and perform all or any of the acts matters of things by this contract, to be observed and performed by the contractor within three clear days after the notice shall have been given to the contractor in manner hereinafter mentioned requiring the contractor to observe or perform the same or shall use improper materials of workmanship in carrying on the works, or shall in the opinion of the employer not exercise such due diligence and make such progress as would enable the work to be completed within due time agreed upon, and shall fail to proceed to the satisfaction of the employer after three clear days notice requiring the contractor so to do shall have been given to the contractor as hereinafter mentioned or shall abandon the contract, then and in any of the said cases, the Bank may notwithstanding previous waiver determine the contract by a notice in writing to the effect as hereinafter mentioned, but without thereby effecting the powers of the Bank of the obligations and liabilities of the contractor the whole of which shall continue in force as fully as if the contract, had not been so determine and as if the works subsequently executed by or on behalf of the contractor (without thereby creating any trust in favour of the contractor) further the Bank or his agent, or servants, may enter upon and take possession of the work and all plants tools scaffolding sheds machinery, steam, and other power, utensils and materials lying upon premises or the adjoining lands or roads and sell the same as his own property or may employee the same by means of his own servants and workmen in carrying on and completing the works or by employing any other contractors or other persons or person to complete the works, and the contractor shall not in any way interrupt or do any act, matter or thing to prevent or hinder such other contractors or other persons or person employed from completing and finishing or using the materials and plants for the works when the works shall be completed, or as soon thereafter as conveniently may be the employer shall give notice in writing to the contractor to remove his surplus materials and plants and should the contractor fail to do so within a period of 14 days after receipt by him the employer may sell the same by Public Auction and shall give credit to the contractor for the amount so realized. Any expenses or losses incurred by the employer in getting the works carried out by other contractors shall be adjusted against the amount payable to the contractor by way of selling his tools and plants or due on account of work carried out by the contractor prior to engaging other contractors or against the Security Deposit. Any change in Term conditions and Variation can be accepted by permission of Regional Head Only.

69. **ARBITRATION:** The Purchaser and the supplier shall make every effort to resolve amicably by direct informal negotiation any disagreement or dispute arising between them under or in connection with the Contract.

If, after thirty (30) days, the parties have failed to resolve their dispute or difference by such mutual consultation, then either the Bank or the contractor may give notice to the other party of its intention to commence arbitration, as hereinafter provided, as to the matter in dispute, and no arbitration in respect of this matter may be commenced unless such notice is given.

Any dispute or difference in respect of which a notice of intention to commence arbitration has been given shall be finally settled by arbitration. Arbitration may be commenced prior to or after delivery of the Goods under the Contract.

In case of Dispute or difference arising between the Purchaser and a domestic supplier relating to any matter arising out of or connected with this agreement, such disputes or difference shall be settled in accordance with the Arbitration and Conciliation Act, 1996. The arbitral tribunal shall consist of 3 arbitrators one each to be appointed by the Bank and the Contractor. The third Arbitrator shall be chosen by the two Arbitrators so appointed by the Parties and shall act as Presiding arbitrator. In case of failure of the two arbitrators appointed by the parties to reach upon a consensus within a period of 30 days from the appointment of the arbitrator appointed subsequently, the Presiding Arbitrator shall be appointed by the *Indian Council of Arbitration/President of the Institution of Engineers (India)/The International Centre for Alternative Dispute Resolution (India).

In the case of a dispute with a Foreign Supplier, the dispute shall be settled in accordance with provisions of UNCITRAL (United Nations Commission on International Trade Law) Arbitration Rules. The Arbitral Tribunal shall consist of three Arbitrators one each to be appointed by the Purchaser and the Supplier. The third Arbitrator shall be chosen by the two Arbitrators so appointed by the Parties, and shall act as presiding arbitrator. In case of failure of the two arbitrators appointed by the parties to reach upon a consensus within a period of 30 days from the appointment of the arbitrator appointed subsequently, the Presiding Arbitrator shall be appointed by the Appointing Authority namely Indian Council of Arbitration OR President of the Institution of Engineers (India) OR The International Centre of Alternative Dispute Resolution (India) as specified in the SCC.

If one of the parties fails to appoint its arbitrator in pursuance of sub-clause (a) and (b) above, within 30 days after receipt of the notice of the appointment of its arbitrator by the other party, then the Appointing Authority, both in cases of the Foreign supplier as well as Indian supplier, shall appoint the arbitrator. A certified copy of the order of the Appointing Authority, making such an appointment shall be furnished to each of the parties.

Arbitration proceedings shall be held in India at the place specified in the SCC and the language of the arbitration proceedings and that of all documents and communications between the parties shall be English.

The decision of the majority of arbitrators shall be final and binding upon both parties. The cost and expenses of Arbitration proceedings will be paid as determined by the arbitral tribunal. However, the expenses incurred by each party in connection with the preparation, presentation etc. of its proceedings as also the fees and expenses paid to the arbitrator appointed by such party or on its behalf shall be borne by each party itself.

Where the value of the contract is Rs. 2 crores and below, the disputes or differences arising shall be referred to the Sole Arbitrator. The Sole Arbitrator should be appointed by agreement between the parties; failing such agreement, by the Appointing Authority (namely the Indian Council of Arbitration OR President of the Institution of Engineers (India) OR The International Centre for Alternative Dispute Resolution (India) as specified in the SCC).

Notwithstanding any reference to arbitration herein,

- (a) the parties shall continue to perform their respective obligations under the Contract unless they otherwise agree; and
- (b) the Purchaser shall pay the Supplier any monies due the Supplier.

SPECIAL CONDITION OF THE CONTRACT

1. **TENDER :** Tenders are to be submitted in details as set out in the Schedule of Quantities and must be completed in all respects. The Bank reserves the right to discharge any or all the tenders for each section or split up and distribute any item of work to any specialist firm or firms without assigning any reason. No stipulation/condition (commercial or technical) other than the tender should be enclosed by the contractor in any of the tender envelopes/covers or inserted on the body of the tender papers issued, in which case this may be liable to rejection.
2. **RATES QUOTED:** The rates quoted in the tender shall be for the finished items of work. The rates quoted shall include all the charges required for labour, material, sheds for storage of materials, transportation of material and equipment, tools and plants, cleaning of sites during execution/completion of various items of work, overheads, supervising staff salary etc. The rates quoted shall also include all duties, royalties, cess, sales tax on materials, income tax, service tax, octroi, sales tax on work contract or any other taxes or local charges or duties etc. as applicable till the completion of work. No extra claim will in any case be entertained. The rates shall be firm and shall not be subjected to exchange variations due to labour conditions or any other conditions what so ever. **Quoted rates shall be excluding GST.**
3. **PAYMENT:** Payment will be made by the Bank after receipt and check of the contractors bill by the Bank's Civil Engineer after deduction of income tax, sale tax on work contract, Security deposit, etc. as per statutory rules and terms of tender for the value of authorized work executed as per specifications and drawings. For this purpose the contractor must submit his on account bills on the prescribed form duly accompanying the detailed measurements in support and showing deductions for the provisional payments received by him. The security money thus retained from all bills and initial security deposit will become payable only after 12 months after final completion of work as per specifications, design and drawings. The Employer is not liable to pay any interest on the security money thus retained.
4. **VALIDITY OF PRICE:** The contractor shall have no right to ask for the alteration of the rates, terms and conditions quoted by the contractor and shall be final and to be subsisting and valid for the execution of the work.
5. **LOWEST TENDER :** The employer shall have the right to reject any or all the tenders and will not be bound to accept the lowest or any tender and the tenderer or tenderers shall have no right to question the acts of the employer in this respect.
6. **CO-OPERATION:** The contractor will be required to consult and co-operate with other contractors whose work may be affected by the work under this contract.
7. **TREASURE TROVE ETC.:** Any treasure trove, coin or object antique which may be found on the site shall be the property of the employer and shall be handed over to the Bank.
8. **WATER SUPPLY, LATRINE ETC.:** The selected tenderer shall make his own arrangements at his own costs for the supply of approved quality water required for construction and for drinking purposes and shall provide at his costs all tubes, fittings and temporary plumbing works required and on completion of the works, shall remove all temporary appliances and make good any work disturbed for making such arrangements to the satisfaction of the employer.
9. **ELECTRIC SUPPLY:** Electricity for execution purpose (tools & plants, lighting) will be provided by the Bank free of cost. Only supply point/source will be provided by the Bank. Contractor has to make his own arrangement of supply system like temporary switch board, temporary Electric panel board, wires, measurements meters, running & maintenance of plants etc. at his own cost. Contractor has to ensure for proper supply of electricity at its own risk. Bank is not liable for any damages of contractor's tool & plants, machinery or anything else caused due to high voltage, short circuits, electric shock to labors/contractor's

representative etc. or due to any other reasons. No contractor's claim compensations shall be entertained/ payable.

10. **METHOD OF MEASUREMENT:** Unless otherwise mentioned in the Schedule of Quantities measurements will be on the net quantities of work produced in accordance with up-to-date rules laid down by the Indian Standards Institution. In the event of any dispute in regard to the measurements of the work executed, the decision of the Bank shall be final and binding on the contractor.

11. **NOTICE TO BE GIVEN BEFORE WORK IS COVERED UP:** The contractor shall give not less than 5 days notice in writing to Bank before covering up or otherwise placing beyond the reach of measurement, any work in order that the same may be measured and correct dimensions thereof be taken before the same is so covered up or placed beyond the reach any work without the consent in writing of the Bank. If any work shall be covered up or placed beyond the reach of measurement without such notice having been given or consent obtained, the same shall be uncovered at the contractor's expenses, or in default thereof no payment or allowance shall be made for such work or the materials, with which the same was executed.

12. ACTION WHERE NO SPECIFICATION / CONTRADICTION

A). The work is to be carried out by combining the details in Schedule of quantities, Drawings and Technical specifications. If there is any discrepancy / contradiction between Schedule of quantities, Drawings and Technical specification, the first preference is given to Description in schedule of quantities, second to drawings and third to Technical specifications.

B). In the case of any item of work for which there is no specification in Technical Specifications, such work shall be carried out in accordance with the I.S./CPWD Specification and in the event of there being no I.S./CPWD Specification, then in such case the work shall be carried out in all respects in accordance with the instructions and requirements of the Bank.

13. **WORKMEN'S COMPENSATION ACT :** The contractor shall ensure that workmen employed by him for execution of work are suitably covered against Workmen's Compensation Act and that all liabilities arising out of Workmen's Compensation Act, ESIS and other legislative enactments applicable, to such works and workmen shall be to the contractor's account.

14. **GATEKEEPER AND WATCHMAN:** The contractor from the time of being placed in possession of the site must make arrangement for watching, lighting and protecting the work, all materials, workmen and the public by day and night on all days including Sunday and holidays at his own cost. The contractor shall make adequate arrangement for watch and ward of his material and shall ensure the safety, breakage and any theft of material fixed or unfixed by him.

15. **Contractor Not To Deposit Materials In A Manner That May Cause Inconvenience To The Public:** The contractor(s) shall not deposit materials on any site which will seriously inconvenience to the public. The Employer may require the contractor to remove any or all materials, which are considered by him to be a danger or inconvenience to the public or cause them to be removed at the contractor's cost.

16. **LIQUIDATED DAMAGES:** Time is the essence of the contract. The completion of the works is essential to comply with various requirements of the bank. Thus the contractor shall beware and take a note that non-completion of the works will affect the Bank's committed programs and thus the loss by way of delayed completion of related works etc, are invaluable and cannot be easily assessed. Therefore, it is part of the agreed terms that in the event of any delay in completion of the work, the Bank is liable to charge the Contractor without the necessity of providing for any details of such losses suffered by the Bank.

Thus if the Contractor fails to complete the works within the time for completion in the Notice Inviting the Tender or extended time in writing by the Bank, the Contractor shall pay the Employer the sum of the rate of 0.25% per day subject to maximum of 5% of contract value for the period during which the said works shall so remain incomplete. The Bank shall have the right to adjust, / set-off against any sum payable to the contractor under this or any other contract with the Employer.

17. The work executed should be got approved by the Bank and contractor shall rectify and bad workmanship pointed out at any stage and remove from site all the rejected material
18. The contractor will attend to all defects noticed during defect liability period. If the contractor fails to attend to the defects within a reasonable time these defects will be rectified by the Bank and the expenditure incurred on this account will be recovered from security deposit, or any other money due on to time.
19. The contractor shall remove all rubbish etc. out of site/premises wash and clean the floors and hand over the site in proper and tidy condition on the completion of work at his own cost.
20. The contractor will take necessary precautions for carrying out the work avoiding any damage to fixed or loose furniture, structures/decorative parts of the property. The contractor will rectify any damages done at his cost.
21. Applicable Income-Tax of the Bill Amount will be deducted at source from the contractor's bill and will be deposited with the I.T.O as per rules.
22. The Bank may delay the progress of work without, in any way, vitiating the contract and grant such extension of time for the commencement/completion of the contract as it may think proper and sufficient in consequence of such delay and the contractor shall not make claim for compensation of damages in relation thereof.
23. The Contractor will not execute any extra item without Bank's permission in writing.
24. The quantities mentioned in the schedule of quantities are approximate. Payment will be on actual work done by the contractor. However the contractor should not deviate the quantity without Bank's permission.
25. The Bank has a right to alter the nature of work and to add or omit any items of work or to have the option of the same carried out departmentally or otherwise and such alterations or variations shall be carried out without prejudice to this contract.
26. Measurement for all items shall be taken as per actual work done and no claim for any wastage in all material shall be considered.
27. Contractor has to prepare sample of chair, table and part counter for the approval of the Bank.
28. Contractor must quote balanced rates as quantities mentioned in the tender are approximate and may vary to any extent. No extra shall be given on this account.
29. Contractor has to submit Photographs of the completed furnishing work in duplicate along with soft copy in from of C.D.
30. Contractor shall have prepared any No of samples as directed by Architect/Bank before finalizing of scheme. For this No extra payment shall made.
31. Tender, without tender fee & EMD will be rejected.

FORM OF AGREEMENT

(सफल बोलीकर्ता द्वारा रु.300/- के गैर अदालती स्टॉप पेपर पर निष्पादित किया जाए)
(On Rs.300/- non-judicial stamp paper by the successful bidder)

ARTICLES of AGREEMENT made this ____day ____Months____ year between the Regional Head Gandhinagar Central Bank of India having its Regional Office at , 4th floor, Lal Darwaza Building, Ahmedabad. (Hereinafter referred to as the “Employer/Owner” which expression shall, unless excluded by or repugnant to the context, includes its successors and assigns) of the ONE PART and M/s_____ duly represented by one of its proprietor/partner Mr./Mrs._____ aged _____S/O Shri_____ residence at_____ and having their office at _____ (Hereinafter referred to as “Contractor” unless excluded by or repugnant to the context, includes its successors and assigns) of the OTHER PART.

AND WHEREAS for the purpose of the said project, the Employer invited sealed tenders from experienced, resourceful and bonafide contractors vide his Notice Inviting Tender (No.____dated.).

WHEREAS the contractor submitted his Tender along with the Tender Documents containing General Notes, General Conditions of the Contract, Special Conditions, Layout, and Schedule of Quantities etc. for the works (Hereinafter collectively referred to as the “said conditions”), duly signed on each page as a token of his acceptance of the same, along with requisite Earnest Money Deposit of Rs. 48,000.00.

AND WHEREAS out of the Tenders received, the Tender of the contractor was found to be most suitable for the project.

AND WHEREAS the Employer has accordingly issued the work order (No.____dt.____) to the contractor subject to his furnishing the requisite Security Deposit.

AND WHEREAS the Contractor has accepted the aforesaid Work Order vide his letter of acceptance No____.dt.____(Copy enclosed Vide Annexure-I) and has also deposited with the Employer a sum of Rs.____which with the Earnest Money of Rs. 48,000.00 forms the requisite Security Deposit @ 2% of the accepted Tender Value of Rs._____.

AND WHEREAS the Employer has caused the plans, drawings, specifications, schedule of quantities etc. relating to the project at the works site at _____to be issued to the contractor

NOW, therefore, it is hereby agreed to and between the party as follows:

1. Contract documents

The following documents shall constitute the Contract Documents.

- i. This Article of Agreement.
- ii. Tender submitted by the Contractor included the N.I.T and Tender Documents (Vide Annexure - I).
- iii. Corrigendum to tender document if any.
- iv. All correspondence between the Bank and the Contractor from the date of issue of N.I.T and the date of issue of work order.
- v. Work order No.____dt.____ (Vide Annexure-II).

[Type text]

- 2) In consideration of the payments to be made to the Contractor as hereinafter provided the Contractor shall upon and subject to the said conditions, execute and complete the contracted works shown upon the said drawings etc. and such further detailed drawings as may be furnished to the contractor by the said Owner/Employer and described in the said Specifications and the said Schedule of Quantities.
- 3) Notwithstanding what are stated in the N.I.T conditions of Tendering, Conditions of Contract of herein before stated, Employer reserves itself the right of altering the drawings and the nature of the work and addition to or omitting any items of work or of having portions of the same carried out departmentally or otherwise and such alterations or variations shall be carried out without prejudice to this contract.
- 4) As mentioned in Article 1 above, the said conditions shall be read and be treated as forming part of this agreement and parties hereto will respectively be bound thereby and to abide by and submit themselves to the conditions and stipulations and perform the same on their parts to be respectively observed and preferred.
- 5) Any dispute arising under this agreement shall be referred to the Arbitration in a manner specified in the General Conditions of the Contract and all legal disputes shall be limited within the territorial jurisdiction of GANDHINAGAR thereto. The decision of the arbitration shall be final and binding on both the parties.

IN WITNESS WHEREOF THE PARTIES to their presents have hereunder set and subscribed their hands, the day, month and year first above written.

On Behalf of Contractor & Seal

On Behalf of Central Bank of India.

Witness

1) _____

2) _____

Safety Codes

- (i) Suitable scaffolds should be provided for workmen for all works that cannot safely be done from the ground, or from solid construction except such short period work as can be done safely from ladders. When a ladder is used an extra mazdoor shall be engaged for holding the ladder and if the ladder used for carrying material as will, suitable footholds and hand holds shall be provided on the ladder and the ladder shall be given an inclination not steeper than 1/4 to 1 (1/4) horizontal and 1vertical)
- (ii) Scaffolding or staging more than 4m. above the ground or floor, swung or suspended from an overhead support or erected with stationary support shall have a guard rail properly attached bolted, braced and otherwise secured at least 3 feet high above the floor or platform of such scaffoldings or staging and extending along the entire length of the outside and ends thereof with only such opening as may be necessary for the delivery of materials. Such scaffolding or staging shall be so fastened as to prevent it from swaying from the building or structure.
- (iii) Working platform, gangways, and stairways should be so constructed that they should not sag unduly or unequally, and if the height of the platform or the gangway or the stairway is more than 12feet above the ground level on the floor level. They should be closely boarded, should have adequate width and should be suitably fastened, as described in (ii)above.
- (iv) Every opening in the floor of a building or in a working platform be provided with suitable means to prevent the fall of persons or materials by providing suitable fencing or railing whose minimum height shall be -3'0". Wherever there are open excavations in ground, they shall be fenced off by suitable railing and danger signals installed at night so as to prevent persons slipping into the excavations.
- (v) Safe means of access shall be provided to all working platforms and the working places. Every ladder shall be securely fixed. No portable single ladder shall be over 9m. in length while the width between side rail in rung ladder width shall in no case be less than 290mm. for ladder up to and including 3m. in length. For longer ladders this width should be increased at least 20mm. for each additional meter or length.
- (vi) All personnel of the contractor working within the plant site shall be provided with safety helmets. All welders shall wear welding goggles while doing welding work and all metal workers shall be provided with safety gloves. Persons employed on metal cutting and grinding shall wear safety glasses.
- (vii) Adequate precautions shall be taken to prevent danger from electrical equipment. No materials on any of the sites of work shall be so stacked or placed as to cause danger or inconvenience to any person or the public.

TECHNICAL SPECIFICATIONS FOR CIVIL / FURNITURE WORKS

General: This specifications are for the work to be executed items to be supplied and materials to be used in the works as shown and defined on the drawings and described here in all under the supervision and to the satisfaction of the Bank. The workmanship is to be the best available and to a high standard. Use must be made of specialist tradesmen in all aspects of the works, and allowance must be made in the rates for doing so. The materials and items to be provided by the contractor shall be the best of their respective kinds, approved by the architect in accordance with any samples, which may be submitted for approval, and generally in accordance with the specification. Where materials or products are specified in this specification and/ or bill of quantities by the name of the manufacture or the brand trade name or catalogue references the contractor will be required to obtain the approval of the Bank before using a material or product other than the specified. The contractor shall produce all invoices, vouchers or receipted accounts for any materials of called upon to do so by the architect. Sample of all material are to be submitted to the architect for his approval before the contractor orders or delivers in bulk to the site. Also, the contractor will be required to submit specimen finishes to colors, fabrics etc. For the approval of the architect before proceeding with the works. Should it be necessary to prepare shop drawings, then four copies of such drawings shall be submitted for the approval of the architect who will retain to copies, all at the contractors expenses.

MATERIAL-1: TEAK WOOD

The teakwood shall be of good quality as required for the item to be executed. When the kind of Wood is not specifically specified, Indian teakwood as approved by the Architect/Engineer-In-charge shall be used. Teak wood shall be generally be free from large, loose, dead or clustered knots, flows. Shakes, Warps, twists, bends or any other defects. The teakwood shall generally be uniform in substance and having straight fiber as far as possible. It shall be free from rot, decay, harmful fungi and other damage of harmful nature which will affect the strength, durability or its usefulness for the purpose for which it is required. The color of the teakwood shall be uniform. Any effort like pointing, using any adhesive or reasons materials made to hide the defects shall render the pieces liable to be rejected by the Architect. The teak wood shall be dry and kiln seasoned. Green and wet timber shall be rejected.

All scaffoldings, planks, etc. shall be sown in straight lines and planed in the direction of the grains in uniform thickness to the size specified. Under no circumstances roughly worked or pieces damaged while being sawed or planed shall be accepted. The tolerance for the dimensions shall be allowed at the ratio 1.50 mm. per face to be planed. Teak wood brought from the timber mart/ prepared at site shall be stored as per category size on Successive cross layers as directed by the Bank. In no case the stacking shall be done so as to result in bending of teak wood members. The bottom most members shall not be directly be rested on ground but kept raised from floor in leveled manner so as not to be affected by moisture and insects. In case if the prepared teak wood members are to be stored for a period of more than 10 days the same shall be applied with approved quality anti termite liquid. The prepared timber shall be stored in shade in dry condition. Under no circumstance the prepared timber shall be tied with rope or hemp string to avoid rope burns. The area where such prepared fiber is stored shall be adequately being protected against fire hazards.

MATERIAL-2: PLYWOOD:

The plywood to be used shall be of approved make as shown in the appendix. All plywood should confirm with respective I.S. standard code. Plywood shall be used in one piece only joining of pieces to form one single piece shall not be permitted except in exceptional case where architect's written permission shall be necessary. All exposed edges of plywood shall be finished with T.W. lapping of appropriate size as shown in the drawings and as instructed by the Bank.

MATERIAL-3: LAMINATES

Laminates shall be of approved make in order of preference shown in the list of approved makes. The laminates used shall be of approved type, finish etc. and shall not be less than 1.00 mm in thickness. The colour, shade & luster finish of laminates shall have to be approved by the Bank, The contractor shall deposit samples of

approved laminates with the Bank & the Architect and shall keep a set on display at site of work till completion of work. Laminates shall be stored flat and so covered as not to damage their surface. Damaged, dented, cracked & warped laminates shall not be used. Whenever patterned or wood grained laminates to be used care shall be taken to match the pattern & grains in all directions. Laminates shall be used in single pieces only. In case of surface larger/longer than standard size of 1220 x 2400 mm where joint is unavoidable the same must be worked fine and finished such that it is not noticeable to casual vision. Laminate shall be pressed to fit using glue of approved make. Extreme care shall be used to eliminate bubble formation. Laminate must be securely, evenly and properly be press fitted so as not to leave any portion loose, bubbled, curled, cracked, or with broken edges. Such defective laminated article shall be summarily rejected and shall have to be made a new. Surface of the laminate shall not be damaged in process of press fitting otherwise the same shall be summarily rejected. Wherever so directed by the Architect the contractor shall chamfer the edges of laminates to create apparently sharp seamless joint without any extra cost. Extra care shall be taken to fix laminates on curved surface and it must be ensured that the laminate does not crack in process of such press fitting. If required the contractor shall procure special type of laminate produced by approved make which permits such flexible press fitting without charging any extra cost. After the laminate is press fitted its edges shall be finished smooth, complete surface of the laminate shall be first cleaned completely to remove all temporary marks, adhesive stains etc. and shall be suitably covered to protect the surface from any accidental damage. If any accidental damage is caused prior to handing over of the finished article to the owner the same shall be replaced completely without any extra cost.

MATERIAL-4: LIPPING AND MOULDINGS:

All exposed edges of plywood shall be finished with lapping by means of fitting seasoned superior quality teakwood [Ghana Teak] batten made from seasoned superior quality teakwood free from bends, twists, cracks, splits, knots, and decay of any kind and shall be of width matching to that of plywood and thickness as specified in the Architects drawing but not less than 6 mm thickness in any case. The T. W. batten to be used for lapping shall not have any knots in its length as far as possible the T.W. batten shall be used in single piece for given length, however for length beyond 2400 mm a joint may be permitted which must be in form of a mitered butt joint. Battens with bend, cracks, twists, splintered ends & Knots shall not be permitted to be used for lapping. The lapping shall be carried out by applying glue of approved quality on surface of the ply wood as well the T.W. batten being used for lapping and fixed tight by using headless nails driven deep so as to permit minimal planing if required. Where indicated the batten for tipping shall project beyond the surface to be lipped as shown in the Architects drawing; no extra charge of any kind shall be admissible for lapping of any kind.

Teakwood moldings shall be made from seasoned superior quality teakwood [Ghana Teak] free from bends, twists, cracks, splits, knots, and decay of any kind. The width and thickness of the teakwood moldings shall be as specified in the Architects drawing and suitably oversized T.W. shall be used so as to finally conform to the finished dimensions shown in the Architects drawing. Special care shall be taken in making of curved moldings, which shall be carried out in such a manner so as not to have more than 3 segments per one half round; joints occurring due to use of such segments shall not be visible to casual observer. When molding is to be used in juxtapose with wood grained veneer or laminate the teakwood selected for moldings must be of even color matching to that of veneer/laminate. Teakwood molding shall be fixed tight to the given edge by applying approved quality glue to both the contact edges and then fixing with headless nails driven deep enough to permit smooth finishing at the surface. The molding shall be held tight for not less than 6 hours before any finishing process is carried out on it.

IMPORTANT NOTE:

All furniture items shall be treated with approved quality anti-termite treatment which shall be applied to all sides of finished timber including inside of joints, exteriors etc. which must have effect for not less than five years and shall be suitable for their final finishes.

Material 5: GLASS

All glass shall be of the best quality, free from specks, bubbles, smokes, veins, air holes, blisters and other defects. The kind of glass to be used shall be as mentioned in the item or specification or in the special

provision or as shown in detailed drawings. Thickness of glass panels shall be uniform. The specification of different kind of glasses shall be as under.

FLOAT GLASS: In absence of any specified thickness of float glass in term of weight in item or detailed specification of the item of work the same shall be assumed to be 5mm. Float glass if not specified otherwise shall mean plain, transparent float glass without dry tint or shade.

TOUGHENED GLASS: Glass to be toughened shall be 1st quality float glass free from any defect like waves, bubbles, crack, flacks & shall be of true surface. The glass to be toughened shall be of specified thickness. All the required cuts, holes, beveling, chamfering creation of slots, polishing of edges etc. shall be carried out prior to commencement of toughening process. Toughening process shall be carried out by experienced company and the glass shall be "oven baked" to required temperature which is sustained for specified period. Cooling of glass shall be carried out in proper medium in gradual manner only. Weight of 12mm thick toughened glass shall be @30 Kg/m². All toughened glass shall carry toughening process applicator's logo label of permanent nature on one of the corner edge.

PAINTED GLASS: When painted glass is specified, it shall be "painted glass" of best quality. It shall have one surfaces painted & other surface clear. The painted glass shall be of the approved shade mentioned in the item or as shown in the detailed drawing or as specified. In absence of any specified shade, the shade of painted glass to be supplied "White paint" shall be used.

BEND GLASS: This type of glass shall be treated in machine. The glass shall be bending as may be specified or required. This type of glass shall be supplied as detailed on drawings or as specified or as directed by the Architect.

MATERIAL-6: FIXTURE AND FASTENINGS GENERAL:

The fixtures and fastenings that is but hinges, tees and strap hinges, sliding door bolts, tower bolts, door latch, bath-room latch, handles, door stoppers, casement window fasteners, casement stays, and ventilators catch shall be made of the metal as specified in the item or its specification. They shall be of Stainless Steel as specified. The fixtures shall be heavy, medium or light type as specified. The fixtures and fastenings shall be smooth satin finished and shall be such as will ensure ease of operations. The samples at fixtures and fastenings shall be got approved as regards quality and shape before providing then in position.

HOLDFASTS: Holdfast shall be made from mild steel flat 50mm. thick at one end the holdfast shall be bent at right angle and two no. of 6mm. diameter holes shall be made in it for fixing it to the frame with screws. At the other end the holdfast, shall be forked and bent at right angles in opposite directions.

HINGES: All butt hinges shall be of stainless steel material with its pin also of stainless steel. Standard heavy type hinges shall be used when so specified.

TOWER BOLTS (BARREL TYPE): Mild steel door bolts shall be made in one piece. Knobs of the tower bolts shall be cast and knob fixed in the bolt. In case of brass and aluminum tower bolts, steel spring and ball shall be provided between bolt and the barrel.

DOOR LATCH: The size of door latch shall be taken as the length at latch.

BATHROOM LATCH: Bathroom latch shall be similar to tower bolt. The inside grip length of the handles shall determine the size of the handles. Handles shall have a base plate of length 50mm.

DOOR STOPPERS: Doorstopper shall be either floor doorstopper type or door catch type. Floor doorstopper shall be of overall size as specified shall have rubber cushion.

DOOR CATCH: Door catch shall be fixed at a height of about 900mm. from the floor level such that one part of the catch is fitted on the inside of the shutter and the other part is fixed in the wall with necessary wooden

plug arrangements for approximate fixity. The catch shall be fixed 20mm. inside the face of the door for easy operation of catch.

WOODEN DOOR STOP WITH HINGES: Wooden doorstop of size 100mm x 60mm x 40mm. shall be fixed on the door frame with a hinge of 75mm. size and at a height of 900mm. from the floor level. The wooden doorstop shall be provided with 3 coats of approved all point.

DRAWER SLIDES: The drawer slides shall be of specified make and of slide type. The Drawer slide shall be such as to permit full drawer pull open. The drawer slide shall be fixed in proper line and level and shall operate smoothly.

CABLE MANAGER: The cable manager shall be of specified make and size. The cable manager shall be having powder coated finish. The cable manager shall be fixed at designated place.

MATERIAL-7: PAINTS:

(A) OIL PAINTS: Oil paint shall be of the specified colour and shade, and approved by the Architect/Engineer-in-charge. The ready mixed paints shall only be used. However, if ready mixed paint of specified shade or tint is not available, while ready mixed paint with approved strainer will be allowed. In such a case the contractor shall ensure that the shade of the paint so allowed shall be uniform. All the paints shall meet with the following general requirements:

- I. Paint shall not show excessive setting in a freshly opened full tin and shall easily be mixed with a paddle to a smooth homogeneous state. The paint shall show not cording; livening, caking or colour separation and the same shall be free from lumps and skins.
- II. The paint as received shall brush easily, possess good leveling properties and show no running or sagging tendencies.
- III. The paint shall not skin within 48 hours in a three-quartered filled closed container.
- IV. The paint shall dry to a smooth uniform finish free from roughness, grit, unevenness and other imperfections. Ready mixed paint shall be used exactly as received from the manufacturer and generally according to their instruction and without any admixtures, whatsoever.

(B) SYNTHETIC ENAMEL PAINTS: The enamel paint shall satisfy in general requirements as mentioned in specification of oil points. Enamel paint shall conform to I.S.520/1954 or as revised from time to time.

MATERIAL-9: FOAM FOR UPHOLSTERY WORK

Foam for upholstery work shall be procured from approved make only and shall be of thickness and density as specified. The Foam shall be of fresh stock free from stains, tear, holes, indentation marks and loss of shape and shall be with smooth straight edges. Damaged foam shall be rejected. Use of second hand foam is prohibited. Foam shall be cut by expert workers using suitable tools so as to produce smooth edges free from any jagged appearance. Foam shall be joined using rubber solution of appropriate grade only. As far as possible foam shall be used in single piece only unless a special shape is required to be formed by joining of foam. All foam work shall be protected from damage till suitably covered with grey lining cloth.

MATERIAL-10: TAPESTRY

All tapestry shall be of approved make, shade, pattern and finish. Tapestry shall be selected in close consultation with the architect, engineer and the owner. When pattern is apparent in any given tapestry core shall be taken to ensure that the pattern matches at crucial junctions and that direction of pattern is not vitiated.

[Type text]

The chosen tapestry shall be well protected throughout its use and after the sum is used for upholstery work shall be coated with a fabric protection spray as per manufacturer's specifications and guidelines.

WORKMANSHIP: -

The workmanship shall be first class and to the approval of the Owner / Architects. Scantlings and board shall be accurately sawn and shall be of required width and thickness. All carpenter's work shall be wrought except where otherwise described. The workmanship and joinery shall be accurately set out in strict conformity according to the drawings and shall be framed together and securely fixed in approved manner and with property made joints. All work is to be properly tenoned shouldered, wedged, pinned, braced etc. and property glued with approved quality glue to the satisfaction of the Owner / Architect.

TECHNICAL SPECIFICATIONS FOR ELECTRICAL WORKS

CODES AND STANDARD

The following codes and standards shall be applicable for continuous performance of all electrical equipment to be supplied delivered at site, erected, tested and commissioned. The electrical Equipment offered shall comply with the relevant Indian Standard Specifications, Fire Insurance Regulations Tariff Advisory Committee's Regulations and to Indian Electricity Rules in all respects with all its latest amendments up-to-date.

For guidelines to the Bidder few of the Indian Standards are indicated below :-

IS 3043	-	Code of practice for Earthing
IS 10118	-	Code of practice for Installation of Switchgear.
IS 3106	-	Code of practice for selection installation and maintenance of fuse (upto 650 Volts)
IS 3427	-	Metal Enclosed Switchgear and control gear.
IS 4064	-	Switch fuse units for Industries etc.
IS 4237	-	General requirement for Switchgears not exceeding 1000 volts.
IS 4615	-	Switch Socket Outlets.
IS 5133	-	(Part I) Sheet Steel Boxes.
IS 5216	-	Guide for safety procedures and practice in electric work.
IS 5578	-	Guide for making of insulated conductors.
IS 5908	-	Method of measurements of electrical installation in building.
IS 162	-	Electric power switch gear for indoor and outdoor Installations.
IS 374	-	Ceiling Fans
IS 415	-	Tungsten Filament Lamps.
IS 694	-	PVC insulated cable and cords for Power/Lighting.
IS 732	-	Electrical wiring installation (up to 650 V)
IS 1087	-	Single Pole Tumbler Switch 5 Amps.
IS 1293	-	3 Pin Plugs and Socket outlets.
IS 1554	-	PVC insulated Cables - heavy duty.
IS 1567	-	Metal clad switches up to 100 Amps.
IS 1771	-	Industrial Light fittings with accessories.
IS 6381	-	Specification for constructions and testing of Electrical Apparatus.
IS 2268	-	Call Bells / Buzzers.
IS 2274	-	Code of practice for wiring installations (exceeding 650 Volts).
IS 3854	-	Switches for Domestic and similar Purpose.
IS 2312	-	Exhaust Fans.
IS 2509	-	PVC Electrical conduits.
IS 2675	-	Enclosed Distribution Fuse Boards and cutouts for voltage up to 1000 Volts.
IS 2834	-	L.T. Capacitors.
IS 3043	-	Code of Practice for Earthing.
IS 1646	-	Code of Practice for Fire Safety in Electrical Installation.

The entire electrical installation work shall be strictly complied with the codes and Standards. Rules and Regulations framed under the Indian Electricity Act 1910 and Indian Electricity Rules 1956. Further it shall be carried out as per the Regulations and Rules setout by "Tariff Advisory Committee and or / Fire Insurance Regulations.

(1) CABLES:

1. GENERAL:

MV Cables shall be supplied, inspected, laid, tested and commissioned in accordance with drawing specification, cable manufacturer instructions & as indicated at site by the Architect.

2. MATERIAL:

The MV Cables shall be PVC insulated aluminum / copper conductor armored cable conforming to IS 1554 of 1972 (part -1) laid in trenches, ducts or in cable trays as shown on drawings.

3. **INSPECTION:**

All cable shall be inspected upon receipt at site and checked for any damage during transit.

4. **JOINTS IN CABLES:**

The Contractor shall take care to see that all the cables received at site are apportioned to various locations in such a manner as to ensure maximum utilization and joints in the cable will not be acceptable.

5. **LAYING CABLES:**

Cable should be laid in necessary ladder cable trays provided. While erecting the cables on wall, M.S. spacers are to be erected on wall by means of phil plug / wood screw/cement screw, and then cable is dressed properly and GI saddles to be fixed on spacers by machine screw. GI saddles shall be having minimum 20 G. The fixing of cable shall be minimum 400 apart for horizontal runs and 800 mm apart for vertical runs. Any civil work like breaking, digging and making good is deemed to be included the rate. Identification tags shall be provided at every 20 m. Cable shall be bent to a radius not less than 12 times the overall diameter of the cable, or in accordance with the manufacturer's recommendations whichever is higher

6. **CABLE TERMINATIONS OF MV CABLES AND JOINTS:**

Cables terminations shall be done with suitable brass cable gland and tinned copper cables lugs only. The cable lugs shall generally fixed to the cable cores by crimping processes. Irrespective of the cable and method of termination the core shall be cleaned and immediately be covered with an oxide inhibiting / corrosion inhibiting compound before terminating. The tail end wires shall be finished in an appropriate color by using PVC insulating tapes.

(2) **LIGHTING FIXTURES:**

(A) **SCOPE:**

Manufacturer test supply and delivery at site the specified light fittings.

(B) **STANDARDS:**

Lighting fittings covered against these specifications shall comply with the relevant latest Indian Standards and Codes.

(C) **CONSTRUCTION:**

- (a) The fitting shall be suitable for 240 volts single phase AC supply +/- 5% and frequency 50 Hs. +/- 3%.
- (b) Industrial and decorative fittings shall comprise of mounting rails and other accessories. The decorative fitting shall be provided with louvers as specified. The decorative fittings should be suitable for recessed mounting in the false ceiling fully wired up to terminal block.

(3) **LIGHTING FITTING COMPONENTS / ACCESSORIES:**

(a) **BALLASTS/CHOKES:**

These shall be compact in design, copper wound, low power loss, good heat dissipation with no humming sound and filled with polyester.

(b) **STARTERS:**

The starters shall have hermetically sealed glow switch and radio suppression capacitors suitably designed to withstand striking voltage of tube and to ensure long lamp life. Starter holder shall molded type either made up of phenol-formaldehyde.

(c) **CAPACITORS:**

These shall be low loss types to improve power factor upto 0.91 to 0.95 lag. Capacitor housing made up of corrosion resistant material and shall be hermetically sealed type.

(d) **LAMP HOLDERS:**

These shall be rotary spring-loaded resilient type.

(e) **LAMP FLUORESCENT:**

These shall be cool day light as per the stated wattage of 36W.

(f) **LIGHTING AND POWER PANEL:**

Power and lighting panel shall be made out of 14-gauge sheet steel, vermin and dust proof, compartmentalized vermin and dust proof construction to provide general-purpose indoor/outdoor type of enclosures as per IP-42/IP52 respectively. These shall be suitable for surface or flush mounting as specified. Outdoor lighting panel shall be weather protected and shall also have necessary canopy. Panels shall be equipped with phase and neutral bus bars of adequate capacity and miniature circuit breakers of 10 kA capacities for the incoming and outgoing circuits as specified in panel schedule. Miniature circuit breakers shall be mounted in such a way that operating levers project outside the top Bakelite cover plates. A hinged lockable door to cover the operating knobs shall be provided. In addition panels shall be provided with grounding studs and an engraved name plates etc as per the panel schedule. An earth bus shall be provided. Each circuit phase neutral shall be given ferrule numbers. Complete wiring inside the panel shall be neatly bunched with PVC tape and button. For the outgoing circuits of these panels cable glands, plates, knock outs or conduit entry shall be provided as specified on panel schedule. All metal surfaces shall be cleaned free of rust and given two coats of approved paints by powder coat. Panels shall be wall mounting type having arrangement of mounting frame.

(g) **SWITCHES:**

Switches, manufactured in accordance with IS; 3854 shall be used. Switches in areas where concealed wiring has been adopted shall be flush mounting piano plate type unless otherwise specified.

(h) **CEILING ROSE & LAMP HOLDERS:**

All ceiling Rose and holders shall be ISI marked. Ceiling Rose shall be plate type and lamp holders shall be suitable for BC

(i) **RECEPTACLES:**

Only three-pin type receptacles manufactured in accordance with IS : 1293 shall be used with the third terminal connected to the earth. All receptacles shall be provided with a switch mounted on the same enclosure but shall be a separate unit to facilitate replacement by part. Flush mounting type receptacles adopted and surface type shall be used in other areas.

(j) **OUTLET BOXES:**

Outlet boxes for sockets, switches, fixtures and fan regulators etc. shall be for minimum 16 gauges. M.S. sheet 3" deep with necessary modular plate for mounting switch, sockets etc.

(k) **WIRES:**

Wires shall be PVC insulated 660/1100 Volts grade as per IS : 1554 Conductor shall be of stranded copper and size shall be (min. 1.5 mm²) for lighting and (min 2.5 mm²) for power socket circuits. Red/Yellow/Blue wires for Phases, Black wire for Neutral and Green wire for Earth shall be used. Wiring in conduits without color coding is not acceptable. The lighting layouts furnished by Architect shall indicate approx. locations of lighting fixtures. The Electrical Contractor shall determine, with approval of the Architect or his authorized representative, the exact locations of each fixture in order to avoid interference with mechanical equipment & also with a view to obtain as

uniform illumination as practicable and to avoid objectionable shadows. Conduit run shown on drawing is only indicative. These shall be laid out by the Contractor to suit field conditions. The cost for cable clamps, metal spacers, anchor bolts etc. shall be deemed to have been included in the installation.

(I) SURFACE CONDUIT SYSTEM:

Surface conduit 25mm 16SWG ms conduit / 25mm medium thickness PVC conduit system of wiring shall be adopted, wherever specified in the drawings, Suitable pull boxes or inspection type fittings will be used to facilitate drawing wires.

(4) CONCEALED CONDUITING & WIRING:

- a) Concealed conduiting shall be carried out by medium thick min 25 mm diameter rigid PVC conduit embedded in RCC/brick work with normal accessories like junction boxes, shall also be of same material that of conduit. Only deep junction boxes shall be used for concealed conduit installation. All junction boxes shall be of ample size to permit the wires to be drawn in and out.
- b) Concealed conduits shall be securely fixed to prevent movement during building operation viz. casting of concrete fixing shall be by means of clips or other approved manner so as to ensure that there will no damage or deformation to conduits.
- c) Conduits installed in chases of wall shall be firmly secured by 'U' nails and such fixing shall be adequate to hold the pipes by themselves with chicken mesh covering.
- d) Recessed conduits buried in plaster shall permit a full 6 mm depth of cover over its entire length.
- e) To prevent water dirt or rubbish entering the conduit system during erection plugs shall be utilized.
- f) All bends shall be made utilizing bending spring with the help of heater. The bends shall be long bends to avoid deformation of conduits with necessary couplers where conduits cross expansion joints of the building structure special expansion couplings shall be used or other approved methods adopted.
- g) Wiring shall be carried out with stranded copper conductor PVC insulated color coded wires conforming to IS: 694.
- h) No joints shall be permitted and wires shall be looped from point to point. Wiring shall maintain color code for phases neutral (R, Y, B and black) and green for earthing. The earth wire also shall be drawn inside the conduit and shall be continuous.
- i) At all terminations of wires, the insulation shall be neatly stripped without damaging the conductor. In no case shall bare conductors are allowed to project beyond any insulated shrouding or molding of live terminals.
- j) Installation of terminal blocks will be permitted only where wires can't be terminated directly on terminals in appliances. Connectors should be properly fixed inside box. Unfixed connectors will not be permitted.

The preferred conduit size and capacity of wires shall be as detailed below:

Size of Conduit	SIZE OF WIRE		
	1.5 mm ²	2.5 mm ²	4 mm ²
25 mm	10	7	6
32 mm	15	12	8
38 mm	17	15	10

- k) The size of wires for different circuits will be as per BOQ, but generally as follows:

Lighting points and 5A sockets	-	1.5 mm ²
Circuit wiring/primary point/two or three 5A sockets	-	2.5 mm ²
AC / Geyser	-	4 mm ²

Earthing wire shall be min 1.5 mm² or half of the size of phase wire.

(5) SWITCH SOCKET BOXES:

The switch socket boxes shall be of sheet steel. The min thickness of the sheet shall be 2 mm. The box shall be thoroughly cleaned of grease and rust. The paintings shall be two coats of primer followed by two coats of enamel paint. All boxes shall be provided with earthing terminal. The boxes shall be provided adequate knock out for connection conduits. Proper grouting in the wall / partition will be carried out as directed by Architect. All boxes shall be provided with accessories like plates, mounting arrangements.

(6) SWITCHES AND SOCKETS:

Local switches shall be provided for controlling lighting equipment connected to sockets. All sockets shall be 2-pin and earth type unless otherwise stated. Sockets for AC unit geysers shall be metal clad types unless other wise stated.

In case of false ceiling employing minimum tee grid system, fixtures shall be supported from true ceiling. Exact locations of fixtures shall be finalized in consultation with Air-conditioning Contractors and as indicated on architectural drawings. Wiring above false ceilings shall be left loose in flexible pipe and shall be supported along structures/ceiling. Wiring above false ceiling shall be on surface and below false ceiling it shall be concealed. To facilitate easy maintenance looping back system of wiring shall be followed throughout. Accordingly supply tapings and other interconnections are made only at fixture connector blocks or at switchboards. Intermediate junction boxes shall be used for wire pulling as inspection boxes. All wires in conduit shall be color as specified. Each circuit shall have independent phase neutral and earth wire. Unless otherwise specified, insulated conductors of A.C. supply and D.C. supply shall be bunched in separate conduits.

(7) TELEPHONE SYSTEM:

EPABX for the entire area is located in the Central Wing. Main Junction Box with Krone type Tag-block shall be installed as specified and as shown in the drawing. From EPABX system, Multi pair telephone wire PVC insulated and overall PVC sheathed unarmored cable having tinned copper conductor of 0.51 mm dia. shall be laid through PVC conduit, clamped on the wall or through raceway or through compartments. Due care will be taken while providing the cable through conduit. Suitable Junction Box having no. of tag-blocks shall be provided as indicated. From these tag-blocks 3 pair telephone cable shall be laid. Necessary pool boxes shall be provided at suitable location for pooling the telephone cable. Termination of telephone cable shall be done by trained telephone technicians only. Number ferrules / tags shall be provided for each cable.

(8) EARTHING:

- a) The earthing installation shall be done in accordance with the earthing drawings, Specifications and the standard drawings of reference attached with this document. The entire earthing system shall fully comply with the Indian Electricity Act and Rules framed thereunder. The Contractor shall carryout any changes desired by the electrical Inspector or the owner, in order to make the installation conform to the Indian Electricity Rules at no extra cost. The exact location of earth conductors, earth electrodes and earthing points on the equipment shall be determined at site in consultation with the Architect or his authorized representative. Any changes in the methods, routing, size of conductor etc shall be subject to approval of the Architects.
- b) The earth loop impedance to any point in the electrical system shall have a value, which will ensure satisfactory operation of protective devices.

(9) CONNECTION:

All electrical equipment is to be doubly earthen by connecting two points on equipment to earthing several earth electrodes. The earth grid formed shall be a closed loop as shown in the drawing with earth electrodes connected to the grid with double strip connection. Panels, D.B.s, Conduit trays/steel structured, in which cable has been installed, shall be effectively bonded and earthen. Cable armors shall be earthen at both ends.

(10) TESTING:

- a) Measure the insulation resistance of each circuit without the lamps (load) being in place and it should be more than one M-ohms to earth. The insulation resistance measured as above shall not be less than 50 divided by the number

of points on the circuit provided that the whole installation shall not be required to have insulation greater than one mega ohms.

- b) Check the earth continuity for all socket outlets. A fixed relative position of the phase and neutral connections inside the socket shall be established for all sockets.
- c) The insulation resistance between the case of framework of housing and power appliances and all live parts of each appliance shall not be less than that specified in the relevant Indian Standard Specifications.
- d) On completion of cable laying work the Insulation Resistance (Sectional and overall), Continuity Resistance test, Sheathing continuity test, Earth Test., shall be conducted.

(11) COMMISSIONING:

- a) The Contractor shall obtain the written permission and sanction of commissioning the equipment from Electrical Inspector of I. E. & L. Department of State Government and Supply authority. If required under the specific rules of the Government.
- b) Current and voltage of all the phases shall be measured at the lighting panel busbars with all the circuits switched on with lamps, if required load shall be balance on the three phases.
- c) After inserting all the lamps and switching on all the circuits minimum and maximum illumination level should be measured in the area.

MODE OF MEASUREMENT FOR PAYMENT

1.	Partitions	Length X Height up to the soffit of false ceiling including door frames and doors.
2.	Paneling with Laminate	Length X Height up to the soffit of false ceiling.
3.	Paneling with T.W. Moulding	-do- (including cost of T.W. moulding).
4.	Door Main entrance – Glass – Shutter	Length X Height.
5.	Armstrong False Ceiling	Length X Breadth
6.	Plaster of Paris False Ceiling/ grid false ceiling	Finished surface and actual vertical patta.
7.	Vertical Blinds	Actual size of vertical blinds
8.	Paintings	a) Wall surface – Actual length X Height. b) M.S. Grill / Mesh / Without frame c) M.S. Collapsible gate of one side. d) Cornice – Plain surface of P.O.P. False Ceiling. e) Fully paneled Door / Windows with frame: - 2.5 times area of one side. f) Partly Paneled / Partly glazed doors, windows, partitions with frame and shutters: - 2 times area of one side. g) Fully glazed Window / Partition with frame and shutters: - 1 time area of one side.
9.	Flooring	Finished Length X Breadth

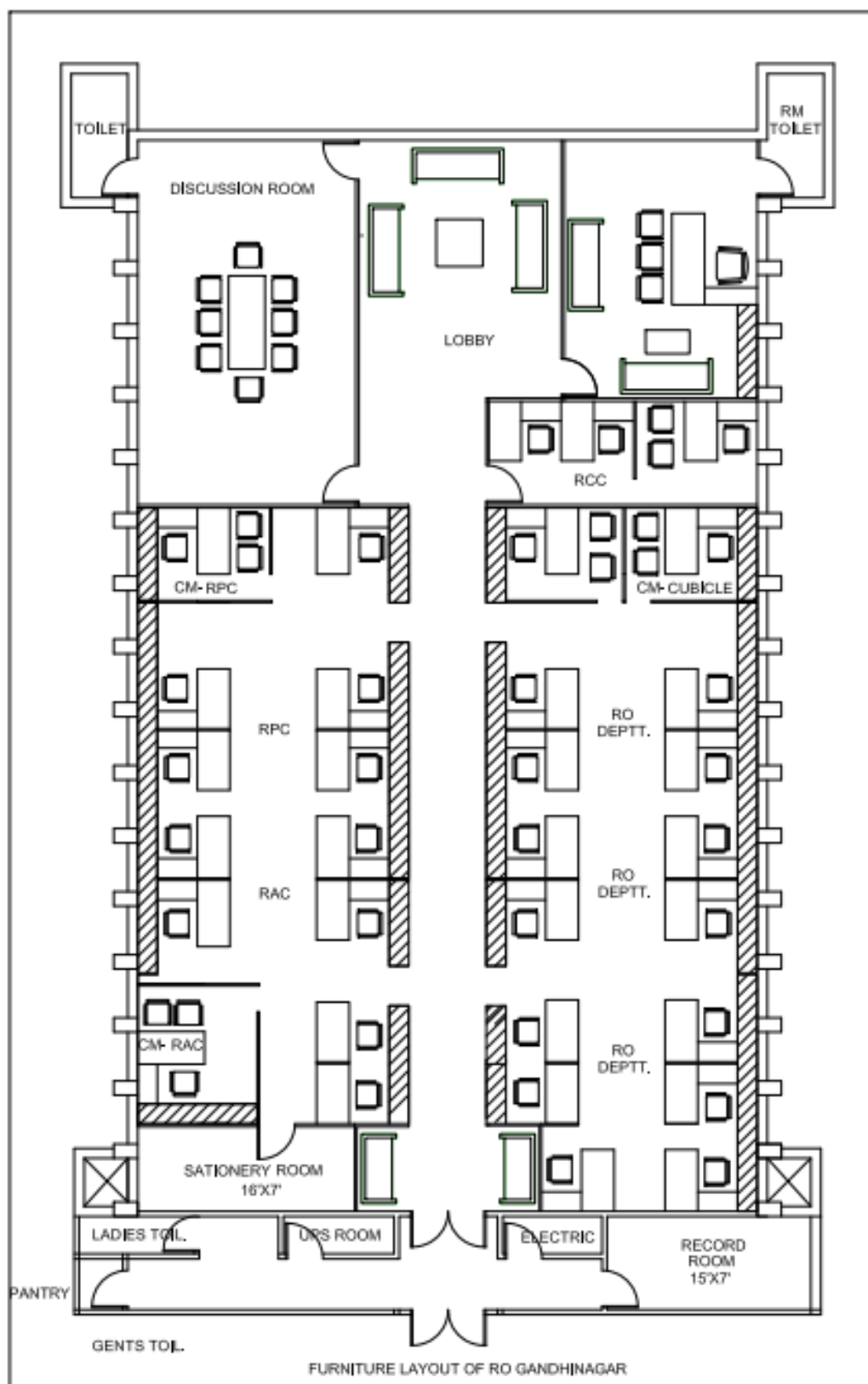

Approved Layout of RO Ganhinagar and CPAC (RPC & RAC) Offices

LIST OF APPROVED MAKES/ MATERIALS: Vendors are advised to Use the materials of below mentioned Brand only.	
MATERIAL	MANUFACTURER / BRAND NAME
False Ceiling	12.5mm thick gypsum board of “ GYPSUM INDIA LTD”
Ply	Century/ Green / Duro/ Archid / Samrat confirming to IS 303, IS 710 & IS 1659.
Armstrong Tiles	600X600, 12-15mm thick perforated tiles of “ ARMSTRONG PVT LTD”
Teak-Wood	Well-seasoned teak-wood / steam beach as per approval Free From All Defects
MDF/ Partition Board/Door	Novapan, Greenlam, Archidlam, Century, mayur or equivalent.
Mortice Locks, Night Latch	Godrej/Laxmi/Vijayan/Equivalent
Multi Purpose Locks	Godrej/ Dorset/ Link/ Harrison
Mouldings	Mouldings - T.W. Wood
Laminate	1mm thk Century, Royal Touch, Formica, Greenlam. Shade- HL Pine
Branding Patta 100 mm	Bank's pattern i.e. Blue: Red = 3:1 as per proportion. Greenlam, Eurolam, Formica. (Blue -C=100 M=50 Y=0 K=0) (Red C=0 M=100 Y=65 K=15)
Glass	Modi Guard/ Saint Gobain/ Ashai
Aluminum	Ajit India, Jindal, Indal, Hindalco
Screw / Nail	G.K.W., Nettle Fold
Rubber/Polyurethane/Tapestry/Leather Foam	Foam of all thickness of 40-50 density HDU Foam of “Dunlop, MM, TATA or equivalent.”.
Hinges	Ozone/Magnum
Hardware	Ozone/Magnum/Everite
Floor Spring (Double action 100kg.- 150kg)	Hemco/ Ozone/ Geze/ Dorma/Everite
Hydraulic Door Closure	Hyper/ Amar/ Samrat/ Godrej/ Everite/ Allwin/ Garnish.
Adhesive	Fevicol, Mahacol, Movicol, Araldite or equivalent.
Tap & Flush coc	CP Finish bibcock and pillar cock, flushcock. “PLUMBER, JENITH, JAL, JAGUAR, MAC, BELL or equivalent.”
Paints	Asian, Berger, ICI, Nerolac
Cement	L&T, ACC, Ambuja, Birla, Binani
Vitrified Tiles	Naveen, Nitco, Asian, Somany, Marbonite, Kajaria, Jhonson
Ceramic Tiles	Nitco/Kajaria
Bonding/ Water Proofing Chemical	Bal/Roffe/Sunanda/Ciba
Chairs	Chairs with fabric Red and Blue as per Bank's standardization “GODREJ, METHODEX, FEATHERLITE, DURIAN, Wipro or equivalent.”
Sanitary Fittings	“HINDWARE/CERA/JOHNSON/PARRYWARE or equivalent.”.
Roller/Venetian Blinds	VISTA, MAC, AUROLUX or equivalent.”.
Plumbing Fittings	G.I. Pipes Jindal, Bindal, Tata Make C-Class, PVC-Supreme, Prince

Approved Make List Electrical

LIST OF APPROVED MAKES/ MATERIALS: Vendors are advised to Use the materials of below mentioned Brand only.		
Sr	Items	Make
1	MCCB, MCB, ELCB, RCCB, ICTPN, TP, HRC Fuse, Change over switch, Switch fuse unit.	L & T , ABB , Legrand, Siemens, Havells
2	FRLS insulated Electric wires/cables Armored/ Unarmored, sheathed, unsheathed, flexible LT cable, multi core, single core cable.	Finolex, Polycab, Havells, Fort Gloster, RR
3	Rotary switches, selector switches	L&T, GE, ABB, Siemens
4	Ceiling fan ,wall bracket fan, Exhaust fan	Crompton, Bajaj, Almonard, GEC, Phillips
5	Light fixtures , LED	Phillips, Wipro, GE, Crompton
6	Electrical, telephone accessories, modular switch, socket, ceiling rose, bulb holder, fan regulator	Anchor, Legrand, crabtree, MK
7	Bell Buzzer	Anchor, Cona, Leader
8	PVC conduit and casing capping	AKJ, BEC,Presto,Modi,Polycab, Precision, ANG, Finolex or equivalent
9	Data Cabling items	D-Link, Digi- link, Anchor, Delton, Polycab, Finolex.
10	Current Transformer	Crompton, L&T, Schneider, Legrand.